

GUIDELINES FOR SUBMITTING HAUL ROUTE APPLICATIONS WITH IMPORT OR EXPORT AMOUNTS GREATER THAN 1,000 CUBIC YARDS

The purpose of this bulletin is to establish guidelines for the minimum information required for a haul route application. A haul route hearing before the Board of Building and Safety Commissioners ("BBSC") is required for all applications for import or export of more than 1000 cubic yards of soil in the "hillside" area, as designated by the current Bureau of Engineering Basic Grid Map No. A-13372, and as referenced in ZIMAS, as a "Special Grading Area."

The following shall be submitted by the applicant to the Board of Building and Safety Commission Office:

1. A completed "Application for Review of Technical Reports and Import Export Routes" (attached) form with a filing fee of \$529.00 for the first 1000 cubic yards and \$100.00 additional for each 1000 cubic yard or portion of 1000 cubic yards, plus surcharges (19% +\$10.00).
2. A completed **Haul Route Questionnaire**. The questionnaire (attached) shall include the location of borrow and/or dispersal sites, all streets included in the route, the proposed truck staging areas, and the maximum gross weight of the trucks when loaded.
3. A completed **Environmental Review Questionnaire** (attached). A copy of the signed applicable environmental document (i.e. Categorical Exemption (CE), Mitigated Negative Declaration (MND), Negative Declaration (ND), or Environmental Impact Report (EIR)), must be submitted with the haul route application or the package will not be accepted.
4. An 8-1/2" x 11" **haul route map** showing the project site, all involved streets along the hauling route, and the direction of travel to and from the end of the route.
5. A copy of the **grading plan**, showing the location and amounts of cut and/or fill, and export/import amounts.
6. A copy of the **Department letter approving soils/engineering/geology reports**, when such reports are required pursuant to L.A.M.C. Section 91.7006.2.
7. One copy of a **300-foot vicinity map** (attached) identifying all lots within a 300 foot radius of the exterior boundaries of the project site. The map shall show public facilities such as schools, hospitals, libraries, and city parks within the vicinity of the project site.
8. A complete list of **property owners and three sets of self-adhesive labels** for all parcels shown within on the 300-foot radius on the vicinity map. The listed owners shall be cross-referenced with the lots identified on the vicinity map.
9. A completed **information accuracy certificate** (attached).

If you have any questions regarding the status of your haul route application, you may contact the Commission Office at (213) 482-0466 or review the status online at, http://ladbs.org/LADBSWeb/LADBS_Forms/Misc/haul_route_status_table.pdf.

Attachments:

Application for Review of Technical Reports and Import-Export Routes

Haul Route Questionnaire

Environmental Review Questionnaire

300 Feet Radius Map Sample

Information Accuracy Statement

District	Log No.
----------	---------

APPLICATION FOR REVIEW OF TECHNICAL REPORTS AND IMPORT-EXPORT ROUTES

INSTRUCTIONS

- A. Address all communications to the Grading Section, LADBS, 201 N. Figueroa St., 3rd Fl., Los Angeles, CA 90012
Telephone No. (213)482-0480.
- B. Submit 3 copies (4 for fault study zone) of reports and 3 copies of application with items "1" through "10" completed.
- C. Check should be made to the City of Los Angeles.

1. LEGAL DESCRIPTION Tract <u>Ord's Survey Ord's Survey Ord's Survey</u> Block <u>70 62, 70, 78 Lots 2, 3 3, 4 4 of</u> <u>70</u> <u>Hayward's Subdivision</u> 3. OWNER <u>1045 Olive, LLC.</u> Address <u>2200 Biscayne Blvd.</u> City <u>Miami, FL</u> Zip <u>33137</u> Phone (Daytime) <u>424-653-2100 x 7332</u>	2. PROJECT ADDRESS: <u>1045 S. Olive Street Los Angeles, CA 90015</u> 4. APPLICANT <u>Taylor Miller, David Evans and Associates</u> Address <u>201 S Figueroa Street, Suite 240</u> City <u>Los Angeles</u> Zip <u>90012</u> Phone (Daytime) <u>213-337-3689</u> Fax
---	---

5. Report(s) Prepared by: N/A

6. Report Date(s): N/A

7. Status of project: Proposed Under Construction Storm Damage
8. Previous site reports? no if yes, give date(s) of report(s) and name of company who prepared report(s)
9. Previous Department actions? no if yes, provide dates and attach a copy to expedite processing.
- Dates

10. Applicant Signature: Taylor A. Melton Position: Civil

(DEPARTMENT USE ONLY)

REVIEW REQUESTED	FEES	REVIEW REQUESTED	FEES	Fee Due \$ _____;
? Soils Engineering		? Import-Export Route		Fee Verified By: _____ Date: _____
? Geology		? Division of Land		
? Combined Soils Engr. & Geol.		? Other		
Supplemental		Sub-total		(Cashier Use Only)
Combined Supplement		One-Stop Surcharge		

ACTION BY:

TOTAL FEE

THE REPORT IS: NOT APPROVED

APPROVED WITH CONDITIONS SEE: BELOW ATTACHED

For Geology

Date _____

For Soils

Date _____

DISTRIBUTION:Owner
Applicant

**Soil Engr
Geologist**

Board Files
Tract File

Inspection:
LA
VN

WLA
SP/WLABI
BMI

**CITY OF LOS ANGELES
DEPARTMENT OF BUILDING AND SAFETY**

HAUL ROUTE QUESTIONNAIRE

JOB ADDRESS: 1045 S Olive Street Los Angeles, CA 90015

LEGAL DESCRIPTION: Tract: Ord's Survey | Ord's Survey | Block: 70 | 62, 70, 78 | Lot(s): 2, 3 | 3, 4 | 4 of
Ord's Survey 70 Hayward's Subdivision

☐ **IMPORT:** _____ cubic yards; ☒ **EXPORT:** 10,182 cubic yards

From: 1045 S Olive Street Los Angeles, CA 90015 To: Dump Site
(Address) (Address)

LOADED TRUCK ROUTE: North on Olive, East on Olympic, South on Hill, East on 18th, On-ramp to I-10 east
at Los Angeles

EMPTY TRUCK ROUTE: Westbound on I-10 (from east), exit at Los Angeles Street, West on 17th Street,
North on Olive Street to site

PROPOSED HAULING DAYS: M T W Th F Sat Sun **HOURS:** From 9 a.m.; To 3 p.m.
(check boxes) ☒ ☒ ☒ ☒ ☒ ☐ ☐ (Generally Approved: 9 a.m. to 3 p.m.)

TYPE OF TRUCKS: ☒ Double Bottom Dump; ☐ 10-Wheeler Dump; ☐ Other: _____



(14 c.y.)



(10 c.y.)

Max. Truck Weight: 80,000 lbs.

LOCATION OF STAGING AREA(S): _____ on site **Max. # of Trucks Staged:** 27
(i.e. street name, on site, etc.)

(a) Total Export/Import:	<u>10,182</u> c.y.	(d) Estimated trucks per hour	<u>26.6</u>
(b) Truck hauling capacity:	<u>14</u> c.y.	(e) Estimated trucks per day	<u>160</u> (e) = (6 hrs) x (d)
(c) Total number of trucks:	<u>728</u> (c) = (a) / (b)	(f) Estimated days of hauling	<u>4.55</u> (f) = (c) / (e)

Owner's Name: 1045 Olive, LLC **Telephone:** 424-653-2100 x 7332 (e-mail): elkhan@crescentheights.com

Address: 2200 Biscayne Blvd. Miami, FL 33137

Street City Zip Code

Applicant's Name: Taylor Miller, David Evans and Assoc. **Telephone:** 213-337-3689 (e-mail): taylor.miller@deainc.com

Address: 201 S Figueroa St, Suite 240 Los Angeles, CA 90012

Street City Zip Code

CITY OF LOS ANGELES
DEPARTMENT OF BUILDING AND SAFETY

ENVIRONMENTAL REVIEW QUESTIONNAIRE

JOB ADDRESS: 1045 S Olive Street Los Angeles, CA 90015

Briefly describe the complete project and include the proposed amount of Import/Export of soil for hauling and the number of residential units, if applicable:

Replace existing uses with a high rise mixed-used development achieving an approximate height of 714 feet and providing a maximum of 800 residential condominium units with ground floor commercial and amenity space

DEPARTMENT OF CITY PLANNING OR PUBLIC WORKS USE ONLY:

- ☐ The Department of City Planning has analyzed this project, which includes the import/export of soil and hauling, and pursuant to State and City Environmental Quality Act (CEQA) Guidelines, has determined it qualifies for a Categorical Exemption (CE) per the attached Notice of Exemption. (Case No. _____)

The Notice of Exemption references the following amount of import/export of soil to be hauled: _____ cubic yards

- ☐ The Department of City Planning or Public Works has analyzed this project, which includes the import/export of soil and hauling, and pursuant to State and City Environmental Quality Act (CEQA) Guidelines, has prepared or has had another agency prepare the ATTACHED Mitigated Negative Declaration (MND). (Case No. _____)

The circulation end date for the above mentioned MND is: _____

The MND references the following amount of import/export of soil to be hauled: _____ cubic yards

Mitigated measures for hauling are found on the following MND pages: _____

Check one of the following boxes:

- ☐ No Comments were received during the circulation period.
- ☐ Yes, Comments were received during the circulation period. These comments and written responses from the agency that prepared the MND are ATTACHED with the MND referenced above.

- ☐ The Department of City Planning or Public Works has analyzed this project, which includes the import/export of soil and hauling, and pursuant to State and City Environmental Quality Act (CEQA) Guidelines, has prepared or has had another agency prepare the ATTACHED Environmental Impact Report (EIR). (Case No. _____)

The circulation end date for the above mentioned EIR: _____

The EIR references the following amount of import/export of soil to be hauled: _____ cubic yards

Mitigated measures for hauling are found on the following EIR pages: _____

Check one of the following boxes:

- ☐ No Comments were received during the circulation period.
- ☐ Yes, Comments were received during the circulation period. These comments and written responses from the agency that prepared the EIR are ATTACHED with the EIR referenced above.

Print: Name of Planning/Public Works staff

Signature

Date

Telephone Number

300 FEET RADIUS MAP SAMPLE

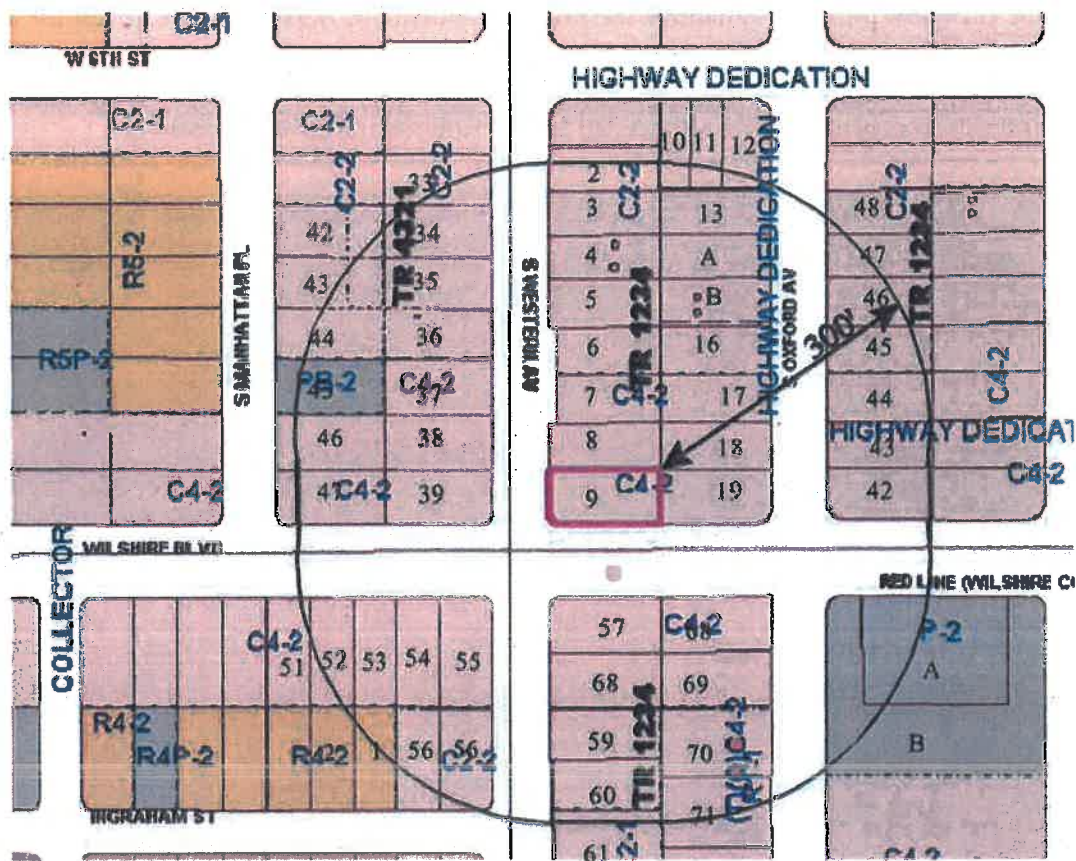

THREE SETS OF LABELS: Labels must contain the current owner's name and mailing address of each lot within the area circumscribed by the 300' radius. Labels must be cross-referenced to the radius map so the owner of each lot can be identified in relationship to the map.

**CITY OF LOS ANGELES
DEPARTMENT OF BUILDING AND SAFETY**

INFORMATION ACCURACY STATEMENT

I hereby certify that, to the best of my knowledge, the attached vicinity map correctly depicts the notification area required by Section 91.7006.7.4 of the Los Angeles Municipal Code. Further, I hereby certify that, to the best of my knowledge, as of _____, the attached list correctly identifies the names and addresses of the
(date list was obtained *)
latest owners of the properties indicated on the attached vicinity map.

Signature

Print Name

Date

* The list must be no older than six months at the time of application.

