

### Districts

#### Name: Chacksfield Tract Residential Historic District



#### Description:

The Chacksfield Tract Residential Historic District is located within the Harbor Gateway area, north of the 91 Freeway and west of the 110 Freeway. It is generally bounded by 168th Street on the north, the 91 Freeway on the south, the 110 Freeway on the east, and Vermont Avenue on the west. It contains 204 contributing and 30 non-contributing properties. The overall topography is flat. Lots are uniform in size overall and rectangular in shape, with uniform setbacks from the street. The streets in the district are somewhat curvilinear and largely cut off from through traffic because of the proximity to the 91 and 110 Freeways. Concrete sidewalks are located alongside streets throughout. The district is comprised of one-story single-family residences designed in the Traditional Ranch House style. The properties have wide driveways, and most of the garages are attached. The district is distinguished by its Japanese-style gardens. The gardens typically include one or more of the following: pruned Japanese black pine trees, Sago palms, "Nana" juniper plants, pruned dwarf eugenias, Pringles or junipers, mondo grass, Japanese stone or cast concrete lanterns, large stones, raked gravel, polished black river rocks, round concrete stepping stones embedded with polished river rocks, and cast concrete posts that mimic logs.

#### Significance:

The Chacksfield Tract Residential Historic District is significant for its role in the post-World War II suburbanization of the Harbor Gateway area. The district's period of significance is 1956 to 1961, reflecting the period when the tracts were laid out and the buildings within the tracts were constructed. The district retains a strong sense to time and place compared to other housing tracts in the area from the same period of time. Approximately 78% of the properties contribute to the significance of the district.

The district is comprised of two tracts that were developed between 1956 and 1957 by George E. Chacksfield Homes Inc. and in 1961 by the Grand Land Company. Chacksfield laid out numerous tracts in Gardena and Harbor Gateway in the 1950s and 1960s. The architects for the Chacksfield Tract were Mel Bogart and Richard Stoddard. Stoddard designed other projects for Chacksfield in the 1960s, and was also the architect for the Grand Land Company. The district is emblematic of a post-war subdivision with curvilinear streets and Traditional Ranch style houses with attached garages. Although no two houses in the district are the same, it is apparent that several models were offered, which could be customized by the selection of different colors, materials, windows, doors, shutters, etc. Common features include wood siding, front-gabled or gable-on-hip attached garages, diamond pane windows, and brick chimneys.

The district had a predominately Anglo American population when it was originally constructed. The Japanese-style landscaping in the front yards reflects the changing demographics of the Harbor Gateway area, which became home to a large Japanese-American community after World War II. The district appears to have transitioned to a predominately Japanese American population in the 1970s; today, the neighborhood is racially mixed.



**Context 1:**

Context:	Residential Development and Suburbanization, 1850-1980
Sub context:	No Sub-context
Theme:	Post-War Suburbanization, 1938-1975
Sub theme:	Suburban Planning and Development, 1938-1975
Property type:	Post-War Suburb
Property sub type:	Subdivision(s)
Criteria:	A/1/1
Status code:	3S;3CS;5S3
Reason:	The district is significant for its role in the post-war suburbanization of the Harbor Gateway area. It is emblematic of a post-war subdivision with curvilinear streets and Traditional Ranch style houses with attached garages. The Japanese style landscaping reflects the changing demographics of the Harbor Gateway area, which became home to a large Japanese American community after World War II.

**Contributors/Non-Contributors:**



Address: 16911 S AINSWORTH ST  
 Type: Contributor  
 Year built: 1965  
 Property type/sub type: Residential-Single Family; House  
 Architectural style: Ranch, Traditional



Address: 16917 1/2 S AINSWORTH ST  
 Type: Contributor  
 Year built: 1965  
 Property type/sub type: Residential-Single Family; House  
 Architectural style: Ranch, Traditional



Address: 16919 S AINSWORTH ST  
 Type: Contributor  
 Year built: 1960  
 Property type/sub type: Residential-Single Family; House  
 Architectural style: Ranch, Traditional



Address: 16923 S AINSWORTH ST  
 Type: Contributor  
 Year built: 1960  
 Property type/sub type: Residential-Single Family; House  
 Architectural style: Ranch, Traditional; Ranch, Oriental



Address: 16929 S AINSWORTH ST  
 Type: Contributor  
 Year built: 1960  
 Property type/sub type: Residential-Single Family; House  
 Architectural style: Ranch, Traditional



Address: 16930 S AINSWORTH ST  
 Type: Contributor  
 Year built: 1960  
 Property type/sub type: Residential-Single Family; House  
 Architectural style: Ranch, Traditional



Address: 16801 S HOOVER ST  
 Type: Contributor  
 Year built: 1957  
 Property type/sub type: Residential-Single Family; House  
 Architectural style: Ranch, Traditional



Address: 16817 S HOOVER ST  
 Type: Contributor  
 Year built: 1957  
 Property type/sub type: Residential-Single Family; House  
 Architectural style: Ranch, Traditional



Address: 16823 S HOOVER ST  
 Type: Contributor  
 Year built: 1957  
 Property type/sub type: Residential-Single Family; House  
 Architectural style: Ranch, Traditional



Address: 16829 S HOOVER ST  
 Type: Contributor  
 Year built: 1957  
 Property type/sub type: Residential-Single Family; House  
 Architectural style: Ranch, Traditional



Address: 16835 S HOOVER ST  
 Type: Contributor  
 Year built: 1957  
 Property type/sub type: Residential-Single Family; House  
 Architectural style: Ranch, Traditional



Address: 16839 S HOOVER ST  
 Type: Contributor  
 Year built: 1957  
 Property type/sub type: Residential-Single Family; House  
 Architectural style: Ranch, Traditional



Address: 16845 S HOOVER ST  
 Type: Non-Contributor  
 Year built: 1957  
 Property type/sub type: Residential-Single Family; House  
 Architectural style: Ranch, Traditional



Address: 16849 S HOOVER ST  
 Type: Contributor  
 Year built: 1957  
 Property type/sub type: Residential-Single Family; House  
 Architectural style: Ranch, Traditional



Address: 16850 S HOOVER ST  
 Type: Contributor  
 Year built: 1957  
 Property type/sub type: Residential-Single Family; House  
 Architectural style: Ranch, Traditional



Address: 16900 S HOOVER ST  
 Type: Contributor  
 Year built: 1957  
 Property type/sub type: Residential-Single Family; House  
 Architectural style: Ranch, Traditional



Address: 16909 S HOOVER ST  
 Type: Contributor  
 Year built: 1957  
 Property type/sub type: Residential-Single Family; House  
 Architectural style: Ranch, Traditional



Address: 16919 S HOOVER ST  
 Type: Contributor  
 Year built: 1957  
 Property type/sub type: Residential-Single Family; House  
 Architectural style: Ranch, Traditional



Address: 16923 S HOOVER ST  
 Type: Contributor  
 Year built: 1957  
 Property type/sub type: Residential-Single Family; House  
 Architectural style: Ranch, Traditional



Address: 17001 S HOOVER ST  
 Type: Contributor  
 Year built: 1957  
 Property type/sub type: Residential-Single Family; House  
 Architectural style: Ranch, Traditional



Address: 17006 S HOOVER ST  
 Type: Contributor  
 Year built: 1957  
 Property type/sub type: Residential-Single Family; House  
 Architectural style: Ranch, Traditional



Address: 17007 S HOOVER ST  
 Type: Non-Contributor  
 Year built: 1957  
 Property type/sub type: Residential-Single Family; House  
 Architectural style: Ranch, Traditional



Address: 17011 S HOOVER ST  
 Type: Contributor  
 Year built: 1957  
 Property type/sub type: Residential-Single Family; House  
 Architectural style: Ranch, Traditional



Address: 17015 S HOOVER ST  
 Type: Contributor  
 Year built: 1957  
 Property type/sub type: Residential-Single Family; House  
 Architectural style: Ranch, Traditional



Address: 17016 S HOOVER ST  
 Type: Contributor  
 Year built: 1957  
 Property type/sub type: Residential-Single Family; House  
 Architectural style: Ranch, Traditional



Address: 17021 S HOOVER ST  
 Type: Contributor  
 Year built: 1957  
 Property type/sub type: Residential-Single Family; House  
 Architectural style: Ranch, Traditional



Address: 17101 S HOOVER ST  
 Type: Contributor  
 Year built: 1957  
 Property type/sub type: Residential-Single Family; House  
 Architectural style: Ranch, Traditional



Address: 17107 S HOOVER ST  
 Type: Non-Contributor  
 Year built: 1957  
 Property type/sub type: Residential-Single Family; House  
 Architectural style: Ranch, Traditional



Address: 17111 S HOOVER ST  
 Type: Contributor  
 Year built: 1957  
 Property type/sub type: Residential-Single Family; House  
 Architectural style: Ranch, Traditional



Address: 17117 S HOOVER ST  
 Type: Contributor  
 Year built: 1957  
 Property type/sub type: Residential-Single Family; House  
 Architectural style: Ranch, Traditional



Address: 17118 S HOOVER ST  
 Type: Contributor  
 Year built: 1957  
 Property type/sub type: Residential-Single Family; House  
 Architectural style: Ranch, Traditional



Address: 17121 S HOOVER ST  
 Type: Contributor  
 Year built: 1957  
 Property type/sub type: Residential-Single Family; House  
 Architectural style: Ranch, Traditional



Address: 17203 S HOOVER ST  
 Type: Contributor  
 Year built: 1957  
 Property type/sub type: Residential-Single Family; House  
 Architectural style: Ranch, Traditional



Address: 17217 S HOOVER ST  
 Type: Contributor  
 Year built: 1961  
 Property type/sub type: Residential-Single Family; House  
 Architectural style: Ranch, Traditional



Address: 17223 S HOOVER ST  
 Type: Contributor  
 Year built: 1961  
 Property type/sub type: Residential-Single Family; House  
 Architectural style: Ranch, Traditional



Address: 17317 S HOOVER ST  
 Type: Contributor  
 Year built: 1961  
 Property type/sub type: Residential-Single Family; House  
 Architectural style: Ranch, Traditional



Address: 17321 S HOOVER ST  
 Type: Contributor  
 Year built: 1961  
 Property type/sub type: Residential-Single Family; House  
 Architectural style: Ranch, Traditional



Address: 17327 S HOOVER ST  
 Type: Contributor  
 Year built: 1961  
 Property type/sub type: Residential-Single Family; House  
 Architectural style: Ranch, Traditional



Address: 17333 S HOOVER ST  
 Type: Contributor  
 Year built: 1961  
 Property type/sub type: Residential-Single Family; House  
 Architectural style: Ranch, Traditional



Address: 17339 S HOOVER ST  
 Type: Contributor  
 Year built: 1961  
 Property type/sub type: Residential-Single Family; House  
 Architectural style: Ranch, Traditional



Address: 17343 S HOOVER ST  
 Type: Non-Contributor  
 Year built: 1961  
 Property type/sub type: Residential-Single Family; House  
 Architectural style: Ranch, Traditional



Address: 16805 S MERIT AVE  
 Type: Contributor  
 Year built: 1957  
 Property type/sub type: Residential-Single Family; House  
 Architectural style: Ranch, Traditional



Address: 16806 S MERIT AVE  
 Type: Non-Contributor  
 Year built: 1957  
 Property type/sub type: Residential-Single Family; House  
 Architectural style: Ranch, Traditional



Address: 16809 S MERIT AVE  
 Type: Contributor  
 Year built: 1957  
 Property type/sub type: Residential-Single Family; House  
 Architectural style: Ranch, Traditional



Address: 16810 S MERIT AVE  
 Type: Contributor  
 Year built: 1951  
 Property type/sub type: Residential-Single Family; House  
 Architectural style: Ranch, Traditional



Address: 16815 S MERIT AVE  
 Type: Contributor  
 Year built: 1957  
 Property type/sub type: Residential-Single Family; House  
 Architectural style: Ranch, Traditional



Address: 16816 S MERIT AVE  
 Type: Non-Contributor  
 Year built: 1957  
 Property type/sub type: Residential-Single Family; House  
 Architectural style: Ranch, Traditional



Address: 16823 S MERIT AVE  
 Type: Contributor  
 Year built: 1957  
 Property type/sub type: Residential-Single Family; House  
 Architectural style: Ranch, Traditional



Address: 16824 S MERIT AVE  
 Type: Contributor  
 Year built: 1957  
 Property type/sub type: Residential-Single Family; House  
 Architectural style: Ranch, Traditional



Address: 16826 S MERIT AVE  
 Type: Non-Contributor  
 Year built: 1957  
 Property type/sub type: Residential-Single Family; House  
 Architectural style: Ranch, Traditional



Address: 16834 S MERIT AVE  
 Type: Contributor  
 Year built: 1957  
 Property type/sub type: Residential-Single Family; House  
 Architectural style: Ranch, Traditional



Address: 16844 S MERIT AVE  
 Type: Contributor  
 Year built: 1957  
 Property type/sub type: Residential-Single Family; House  
 Architectural style: Ranch, Traditional



Address: 16850 S MERIT AVE  
 Type: Contributor  
 Year built: 1957  
 Property type/sub type: Residential-Single Family; House  
 Architectural style: Ranch, Traditional



Address: 16901 S MERIT AVE  
 Type: Contributor  
 Year built: 1957  
 Property type/sub type: Residential-Single Family; House  
 Architectural style: Ranch, Traditional



Address: 16907 S MERIT AVE  
 Type: Contributor  
 Year built: 1957  
 Property type/sub type: Residential-Single Family; House  
 Architectural style: Ranch, Traditional



Address: 16911 S MERIT AVE  
 Type: Contributor  
 Year built: 1957  
 Property type/sub type: Residential-Single Family; House  
 Architectural style: Ranch, Traditional



Address: 16915 S MERIT AVE  
 Type: Contributor  
 Year built: 1957  
 Property type/sub type: Residential-Single Family; House  
 Architectural style: Ranch, Traditional



Address: 16920 S MERIT AVE  
 Type: Non-Contributor  
 Year built: 1957  
 Property type/sub type: Residential-Single Family; House  
 Architectural style: Ranch, Traditional



Address: 16921 S MERIT AVE  
 Type: Contributor  
 Year built: 1957  
 Property type/sub type: Residential-Single Family; House  
 Architectural style: Ranch, Traditional



Address: 16926 S MERIT AVE  
 Type: Non-Contributor  
 Year built: 1957  
 Property type/sub type: Residential-Single Family; House  
 Architectural style: Ranch, Traditional



Address: 16927 S MERIT AVE  
 Type: Contributor  
 Year built: 1957  
 Property type/sub type: Residential-Single Family; House  
 Architectural style: Ranch, Traditional



Address: 16931 S MERIT AVE  
 Type: Contributor  
 Year built: 1957  
 Property type/sub type: Residential-Single Family; House  
 Architectural style: Ranch, Traditional



Address: 16932 S MERIT AVE  
 Type: Contributor  
 Year built: 1957  
 Property type/sub type: Residential-Single Family; House  
 Architectural style: Ranch, Traditional



Address: 16937 S MERIT AVE  
 Type: Contributor  
 Year built: 1957  
 Property type/sub type: Residential-Single Family; House  
 Architectural style: Ranch, Traditional



Address: 16938 S MERIT AVE  
 Type: Non-Contributor  
 Year built: 1957  
 Property type/sub type: Residential-Single Family; House  
 Architectural style: Ranch, Traditional



Address: 16941 S MERIT AVE  
 Type: Contributor  
 Year built: 1957  
 Property type/sub type: Residential-Single Family; House  
 Architectural style: Ranch, Traditional



Address: 16942 S MERIT AVE  
 Type: Contributor  
 Year built: 1957  
 Property type/sub type: Residential-Single Family; House  
 Architectural style: Ranch, Traditional



Address: 17007 S MERIT AVE  
 Type: Contributor  
 Year built: 1957  
 Property type/sub type: Residential-Single Family; House  
 Architectural style: Ranch, Traditional



Address: 17010 S MERIT AVE  
 Type: Non-Contributor  
 Year built: 1958  
 Property type/sub type: Residential-Single Family; House  
 Architectural style: Ranch, Traditional



Address: 17011 S MERIT AVE  
 Type: Contributor  
 Year built: 1957  
 Property type/sub type: Residential-Single Family; House  
 Architectural style: Ranch, Traditional



Address: 17016 S MERIT AVE  
 Type: Contributor  
 Year built: 1957  
 Property type/sub type: Residential-Single Family; House  
 Architectural style: Ranch, Traditional



Address: 17017 S MERIT AVE  
Type: Contributor  
Year built: 1957  
Property type/sub type: Residential-Single Family; House  
Architectural style: Ranch, Traditional



Address: 17020 S MERIT AVE  
Type: Contributor  
Year built: 1957  
Property type/sub type: Residential-Single Family; House  
Architectural style: Ranch, Traditional



Address: 17021 S MERIT AVE  
Type: Contributor  
Year built: 1957  
Property type/sub type: Residential-Single Family; House  
Architectural style: Ranch, Traditional



Address: 17100 S MERIT AVE  
Type: Contributor  
Year built: 1957  
Property type/sub type: Residential-Single Family; House  
Architectural style: Ranch, Traditional



Address: 17103 S MERIT AVE  
Type: Contributor  
Year built: 1957  
Property type/sub type: Residential-Single Family; House  
Architectural style: Ranch, Traditional



Address: 17106 S MERIT AVE  
Type: Contributor  
Year built: 1957  
Property type/sub type: Residential-Single Family; House  
Architectural style: Ranch, Traditional



Address: 17109 S MERIT AVE  
Type: Contributor  
Year built: 1957  
Property type/sub type: Residential-Single Family; House  
Architectural style: Ranch, Traditional



Address: 17112 S MERIT AVE  
Type: Contributor  
Year built: 1957  
Property type/sub type: Residential-Single Family; House  
Architectural style: Ranch, Traditional



Address: 17113 S MERIT AVE  
Type: Contributor  
Year built: 1957  
Property type/sub type: Residential-Single Family; House  
Architectural style: Ranch, Traditional



Address: 17118 S MERIT AVE  
Type: Contributor  
Year built: 1957  
Property type/sub type: Residential-Single Family; House  
Architectural style: Ranch, Traditional



Address: 17119 S MERIT AVE  
Type: Non-Contributor  
Year built: 1957  
Property type/sub type: Residential-Single Family; House  
Architectural style: Ranch, Traditional



Address: 17122 S MERIT AVE  
Type: Contributor  
Year built: 1957  
Property type/sub type: Residential-Single Family; House  
Architectural style: Ranch, Traditional



Address: 17123 S MERIT AVE  
Type: Contributor  
Year built: 1957  
Property type/sub type: Residential-Single Family; House  
Architectural style: Ranch, Traditional



Address: 17201 S MERIT AVE  
Type: Contributor  
Year built: 1957  
Property type/sub type: Residential-Single Family; House  
Architectural style: Ranch, Traditional



Address: 17207 S MERIT AVE  
Type: Contributor  
Year built: 1957  
Property type/sub type: Residential-Single Family; House  
Architectural style: Ranch, Traditional



Address: 17211 S MERIT AVE  
Type: Non-Contributor  
Year built: 1957  
Property type/sub type: Residential-Single Family; House  
Architectural style: Ranch, Traditional



Address: 17301 S MERIT AVE  
Type: Contributor  
Year built: 1961  
Property type/sub type: Residential-Single Family; House  
Architectural style: Ranch, Traditional



Address: 17305 S MERIT AVE  
Type: Contributor  
Year built: 1961  
Property type/sub type: Residential-Single Family; House  
Architectural style: Ranch, Traditional



Address: 17308 S MERIT AVE  
Type: Contributor  
Year built: 1961  
Property type/sub type: Residential-Single Family; House  
Architectural style: Ranch, Traditional



Address: 17311 S MERIT AVE  
Type: Contributor  
Year built: 1961  
Property type/sub type: Residential-Single Family; House  
Architectural style: Ranch, Traditional



Address: 17315 S MERIT AVE  
Type: Contributor  
Year built: 1961  
Property type/sub type: Residential-Single Family; House  
Architectural style: Ranch, Traditional



Address: 17321 S MERIT AVE  
 Type: Non-Contributor  
 Year built: 1961  
 Property type/sub type: Residential-Single Family; House  
 Architectural style: Ranch, Traditional



Address: 17327 S MERIT AVE  
 Type: Non-Contributor  
 Year built: 1961  
 Property type/sub type: Residential-Single Family; House  
 Architectural style: Ranch, Traditional



Address: 17332 S MERIT AVE  
 Type: Contributor  
 Year built: 1961  
 Property type/sub type: Residential-Single Family; House  
 Architectural style: Ranch, Traditional



Address: 16826 S ORCHARD AVE  
 Type: Not sure  
 Year built: 1958  
 Property type/sub type: Residential-Single Family; House  
 Architectural style: Ranch, Traditional



Address: 16827 S ORCHARD AVE  
 Type: Contributor  
 Year built: 1958  
 Property type/sub type: Residential-Single Family; House  
 Architectural style: Ranch, Traditional



Address: 16832 S ORCHARD AVE  
 Type: Contributor  
 Year built: 1958  
 Property type/sub type: Residential-Single Family; House  
 Architectural style: Ranch, Traditional



Address: 16837 S ORCHARD AVE  
 Type: Contributor  
 Year built: 1957  
 Property type/sub type: Residential-Single Family; House  
 Architectural style: Ranch, Traditional



Address: 16838 S ORCHARD AVE  
 Type: Contributor  
 Year built: 1957  
 Property type/sub type: Residential-Single Family; House  
 Architectural style: Ranch, Traditional



Address: 16844 S ORCHARD AVE  
 Type: Contributor  
 Year built: 1957  
 Property type/sub type: Residential-Single Family; House  
 Architectural style: Ranch, Traditional



Address: 16845 S ORCHARD AVE  
 Type: Contributor  
 Year built: 1957  
 Property type/sub type: Residential-Single Family; House  
 Architectural style: Ranch, Traditional



Address: 16852 S ORCHARD AVE  
 Type: Contributor  
 Year built: 1957  
 Property type/sub type: Residential-Single Family; House  
 Architectural style: Ranch, Traditional



Address: 16901 S ORCHARD AVE  
 Type: Contributor  
 Year built: 1957  
 Property type/sub type: Residential-Single Family; House  
 Architectural style: Ranch, Traditional



Address: 16902 S ORCHARD AVE  
 Type: Contributor  
 Year built: 1957  
 Property type/sub type: Residential-Single Family; House  
 Architectural style: Ranch, Traditional



Address: 16910 S ORCHARD AVE  
 Type: Contributor  
 Year built: 1957  
 Property type/sub type: Residential-Single Family; House  
 Architectural style: Ranch, Traditional



Address: 16911 S ORCHARD AVE  
 Type: Non-Contributor  
 Year built: 1957  
 Property type/sub type: Residential-Single Family; House  
 Architectural style: Ranch, Traditional



Address: 16916 S ORCHARD AVE  
 Type: Contributor  
 Year built: 1957  
 Property type/sub type: Residential-Single Family; House  
 Architectural style: Ranch, Traditional



Address: 16917 S ORCHARD AVE  
 Type: Contributor  
 Year built: 1957  
 Property type/sub type: Residential-Single Family; House  
 Architectural style: Ranch, Traditional



Address: 16921 S ORCHARD AVE  
 Type: Contributor  
 Year built: 1957  
 Property type/sub type: Residential-Single Family; House  
 Architectural style: Ranch, Traditional



Address: 16922 S ORCHARD AVE  
 Type: Contributor  
 Year built: 1957  
 Property type/sub type: Residential-Single Family; House  
 Architectural style: Ranch, Traditional



Address: 16927 S ORCHARD AVE  
 Type: Contributor  
 Year built: 1957  
 Property type/sub type: Residential-Single Family; House  
 Architectural style: Ranch, Traditional



Address: 16928 S ORCHARD AVE  
 Type: Contributor  
 Year built: 1957  
 Property type/sub type: Residential-Single Family; House  
 Architectural style: Ranch, Traditional



Address: 16933 S ORCHARD AVE  
 Type: Contributor  
 Year built: 1957  
 Property type/sub type: Residential-Single Family; House  
 Architectural style: Ranch, Traditional



Address: 16934 S ORCHARD AVE  
 Type: Contributor  
 Year built: 1957  
 Property type/sub type: Residential-Single Family; House  
 Architectural style: Ranch, Traditional



Address: 17010 S ORCHARD AVE  
 Type: Contributor  
 Year built: 1957  
 Property type/sub type: Residential-Single Family; House  
 Architectural style: Ranch, Traditional



Address: 17011 S ORCHARD AVE  
 Type: Contributor  
 Year built: 1957  
 Property type/sub type: Residential-Single Family; House  
 Architectural style: Ranch, Traditional



Address: 17016 S ORCHARD AVE  
 Type: Contributor  
 Year built: 1957  
 Property type/sub type: Residential-Single Family; House  
 Architectural style: Ranch, Traditional



Address: 17017 S ORCHARD AVE  
 Type: Non-Contributor  
 Year built: 1957  
 Property type/sub type: Residential-Single Family; House  
 Architectural style: Ranch, Traditional



Address: 17020 S ORCHARD AVE  
 Type: Contributor  
 Year built: 1957  
 Property type/sub type: Residential-Single Family; House  
 Architectural style: Ranch, Traditional



Address: 17021 S ORCHARD AVE  
 Type: Contributor  
 Year built: 1957  
 Property type/sub type: Residential-Single Family; House  
 Architectural style: Ranch, Traditional



Address: 17100 S ORCHARD AVE  
 Type: Contributor  
 Year built: 1957  
 Property type/sub type: Residential-Single Family; House  
 Architectural style: Ranch, Traditional



Address: 17101 S ORCHARD AVE  
 Type: Contributor  
 Year built: 1957  
 Property type/sub type: Residential-Single Family; House  
 Architectural style: Ranch, Traditional



Address: 17106 S ORCHARD AVE  
 Type: Contributor  
 Year built: 1957  
 Property type/sub type: Residential-Single Family; House  
 Architectural style: Ranch, Traditional



Address: 17107 S ORCHARD AVE  
 Type: Contributor  
 Year built: 1957  
 Property type/sub type: Residential-Single Family; House  
 Architectural style: Ranch, Traditional



Address: 17112 S ORCHARD AVE  
 Type: Contributor  
 Year built: 1957  
 Property type/sub type: Residential-Single Family; House  
 Architectural style: Ranch, Traditional



Address: 17113 S ORCHARD AVE  
 Type: Contributor  
 Year built: 1957  
 Property type/sub type: Residential-Single Family; House  
 Architectural style: Ranch, Traditional



Address: 17118 S ORCHARD AVE  
Type: Contributor  
Year built: 1957  
Property type/sub type: Residential-Single Family; House  
Architectural style: Ranch, Traditional



Address: 17119 S ORCHARD AVE  
Type: Contributor  
Year built: 1957  
Property type/sub type: Residential-Single Family; House  
Architectural style: Ranch, Traditional



Address: 17122 S ORCHARD AVE  
Type: Contributor  
Year built: 1957  
Property type/sub type: Residential-Single Family; House  
Architectural style: Ranch, Traditional



Address: 17123 S ORCHARD AVE  
Type: Contributor  
Year built: 1957  
Property type/sub type: Residential-Single Family; House  
Architectural style: Ranch, Traditional



Address: 637 W 168TH PL  
Type: Contributor  
Year built: 1957  
Property type/sub type: Residential-Single Family; House  
Architectural style: Ranch, Traditional



Address: 638 W 168TH PL  
Type: Contributor  
Year built: 1957  
Property type/sub type: Residential-Single Family; House  
Architectural style: Ranch, Traditional



Address: 643 W 168TH PL  
Type: Contributor  
Year built: 1957  
Property type/sub type: Residential-Single Family; House  
Architectural style: Ranch, Traditional



Address: 644 W 168TH PL  
Type: Contributor  
Year built: 1957  
Property type/sub type: Residential-Single Family; House  
Architectural style: Ranch, Traditional



Address: 649 W 168TH PL  
Type: Contributor  
Year built: 1957  
Property type/sub type: Residential-Single Family; House  
Architectural style: Ranch, Traditional



Address: 650 W 168TH PL  
Type: Contributor  
Year built: 1957  
Property type/sub type: Residential-Single Family; House  
Architectural style: Ranch, Traditional



Address: 655 W 168TH PL  
Type: Contributor  
Year built: 1957  
Property type/sub type: Residential-Single Family; House  
Architectural style: Ranch, Traditional



Address: 656 W 168TH PL  
Type: Contributor  
Year built: 1957  
Property type/sub type: Residential-Single Family; House  
Architectural style: Ranch, Traditional



Address: 648 W 168TH ST  
Type: Contributor  
Year built: 1957  
Property type/sub type: Residential-Single Family; House  
Architectural style: Ranch, Traditional



Address: 652 W 168TH ST  
Type: Contributor  
Year built: 1957  
Property type/sub type: Residential-Single Family; House  
Architectural style: Ranch, Traditional



Address: 656 W 168TH ST  
 Type: Contributor  
 Year built: 1957  
 Property type/sub type: Residential-Single Family; House  
 Architectural style: Ranch, Traditional



Address: 660 W 168TH ST  
 Type: Contributor  
 Year built: 1957  
 Property type/sub type: Residential-Single Family; House  
 Architectural style: Ranch, Traditional



Address: 801 W 169TH PL  
 Type: Contributor  
 Year built: 1964  
 Property type/sub type: Residential-Single Family; House  
 Architectural style: Ranch, Traditional



Address: 804 W 169TH PL  
 Type: Contributor  
 Year built: 1960  
 Property type/sub type: Residential-Single Family; House  
 Architectural style: Ranch, Traditional



Address: 805 W 169TH PL  
 Type: Contributor  
 Year built: 1960  
 Property type/sub type: Residential-Single Family; House  
 Architectural style: Ranch, Traditional



Address: 808 W 169TH PL  
 Type: Contributor  
 Year built: 1960  
 Property type/sub type: Residential-Single Family; House  
 Architectural style: Ranch, Traditional



Address: 809 W 169TH PL  
 Type: Contributor  
 Year built: 1960  
 Property type/sub type: Residential-Single Family; House  
 Architectural style: Ranch, Traditional



Address: 812 W 169TH PL  
 Type: Contributor  
 Year built: 1960  
 Property type/sub type: Residential-Single Family; House  
 Architectural style: Ranch, Traditional



Address: 813 W 169TH PL  
 Type: Contributor  
 Year built: 1960  
 Property type/sub type: Residential-Single Family; House  
 Architectural style: Ranch, Traditional



Address: 817 W 169TH PL  
 Type: Contributor  
 Year built: 1960  
 Property type/sub type: Residential-Single Family; House  
 Architectural style: Ranch, Traditional



Address: 637 W 169TH ST  
 Type: Contributor  
 Year built: 1957  
 Property type/sub type: Residential-Single Family; House  
 Architectural style: Ranch, Traditional



Address: 643 W 169TH ST  
 Type: Non-Contributor  
 Year built: 1957  
 Property type/sub type: Residential-Single Family; House  
 Architectural style: Ranch, Traditional



Address: 644 W 169TH ST  
 Type: Contributor  
 Year built: 1957  
 Property type/sub type: Residential-Single Family; House  
 Architectural style: Ranch, Traditional



Address: 649 W 169TH ST  
 Type: Non-Contributor  
 Year built: 1957  
 Property type/sub type: Residential-Single Family; House  
 Architectural style: Ranch, Traditional



Address: 650 W 169TH ST  
Type: Contributor  
Year built: 1957  
Property type/sub type: Residential-Single Family; House  
Architectural style: Ranch, Traditional



Address: 702 W 169TH ST  
Type: Contributor  
Year built: 1957  
Property type/sub type: Residential-Single Family; House  
Architectural style: Ranch, Traditional



Address: 703 W 169TH ST  
Type: Non-Contributor  
Year built: 1957  
Property type/sub type: Residential-Single Family; House  
Architectural style: Ranch, Traditional



Address: 714 W 169TH ST  
Type: Contributor  
Year built: 1957  
Property type/sub type: Residential-Single Family; House  
Architectural style: Ranch, Traditional



Address: 749 W 169TH ST  
Type: Contributor  
Year built: 1957  
Property type/sub type: Residential-Single Family; House  
Architectural style: Ranch, Traditional



Address: 755 W 169TH ST  
Type: Contributor  
Year built: 1957  
Property type/sub type: Residential-Single Family; House  
Architectural style: Ranch, Traditional



Address: 800 W 169TH ST  
Type: Contributor  
Year built: 1957  
Property type/sub type: Residential-Single Family; House  
Architectural style: Ranch, Traditional



Address: 801 W 169TH ST  
Type: Contributor  
Year built: 1957  
Property type/sub type: Residential-Single Family; House  
Architectural style: Ranch, Traditional; Ranch, Oriental



Address: 810 W 169TH ST  
Type: Contributor  
Year built: 1957  
Property type/sub type: Residential-Single Family; House  
Architectural style: Ranch, Traditional



Address: 811 W 169TH ST  
Type: Contributor  
Year built: 1957  
Property type/sub type: Residential-Single Family; House  
Architectural style: Ranch, Traditional



Address: 816 W 169TH ST  
Type: Contributor  
Year built: 1957  
Property type/sub type: Residential-Single Family; House  
Architectural style: Ranch, Traditional



Address: 817 W 169TH ST  
Type: Contributor  
Year built: 1957  
Property type/sub type: Residential-Single Family; House  
Architectural style: Ranch, Traditional



Address: 821 W 169TH ST  
Type: Contributor  
Year built: 1957  
Property type/sub type: Residential-Single Family; House  
Architectural style: Ranch, Traditional



Address: 822 W 169TH ST  
Type: Contributor  
Year built: 1957  
Property type/sub type: Residential-Single Family; House  
Architectural style: Ranch, Traditional



Address: 827 W 169TH ST  
 Type: Contributor  
 Year built: 1957  
 Property type/sub type: Residential-Single Family; House  
 Architectural style: Ranch, Traditional



Address: 832 W 169TH ST  
 Type: Contributor  
 Year built: 1957  
 Property type/sub type: Residential-Single Family; House  
 Architectural style: Ranch, Traditional



Address: 833 W 169TH ST  
 Type: Contributor  
 Year built: 1957  
 Property type/sub type: Residential-Single Family; House  
 Architectural style: Ranch, Traditional



Address: 836 W 169TH ST  
 Type: Contributor  
 Year built: 1957  
 Property type/sub type: Residential-Single Family; House  
 Architectural style: Ranch, Traditional



Address: 837 W 169TH ST  
 Type: Non-Contributor  
 Year built: 1957  
 Property type/sub type: Residential-Single Family; House  
 Architectural style: Ranch, Traditional



Address: 842 W 169TH ST  
 Type: Contributor  
 Year built: 1957  
 Property type/sub type: Residential-Single Family; House  
 Architectural style: Ranch, Traditional



Address: 843 W 169TH ST  
 Type: Contributor  
 Year built: 1957  
 Property type/sub type: Residential-Single Family; House  
 Architectural style: Ranch, Traditional



Address: 641 W 170TH ST  
 Type: Contributor  
 Year built: 1957  
 Property type/sub type: Residential-Single Family; House  
 Architectural style: Ranch, Traditional



Address: 645 W 170TH ST  
 Type: Contributor  
 Year built: 1957  
 Property type/sub type: Residential-Single Family; House  
 Architectural style: Ranch, Traditional



Address: 650 W 170TH ST  
 Type: Contributor  
 Year built: 1957  
 Property type/sub type: Residential-Single Family; House  
 Architectural style: Ranch, Traditional



Address: 651 W 170TH ST  
 Type: Contributor  
 Year built: 1957  
 Property type/sub type: Residential-Single Family; House  
 Architectural style: Ranch, Traditional



Address: 655 W 170TH ST  
 Type: Contributor  
 Year built: 1957  
 Property type/sub type: Residential-Single Family; House  
 Architectural style: Ranch, Traditional



Address: 651 W 171ST ST  
 Type: Contributor  
 Year built: 1957  
 Property type/sub type: Residential-Single Family; House  
 Architectural style: Ranch, Traditional



Address: 656 W 171ST ST  
 Type: Contributor  
 Year built: 1957  
 Property type/sub type: Residential-Single Family; House  
 Architectural style: Ranch, Traditional



Address: 641 W 172ND ST  
Type: Contributor  
Year built: 1957  
Property type/sub type: Residential-Single Family; House  
Architectural style: Ranch, Traditional



Address: 656 W 172ND ST  
Type: Contributor  
Year built: 1957  
Property type/sub type: Residential-Single Family; House  
Architectural style: Ranch, Traditional



Address: 706 W 172ND ST  
Type: Contributor  
Year built: 1957  
Property type/sub type: Residential-Single Family; House  
Architectural style: Ranch, Traditional



Address: 710 W 172ND ST  
Type: Contributor  
Year built: 1957  
Property type/sub type: Residential-Single Family; House  
Architectural style: Ranch, Traditional



Address: 716 W 172ND ST  
Type: Contributor  
Year built: 1957  
Property type/sub type: Residential-Single Family; House  
Architectural style: Ranch, Traditional



Address: 722 W 172ND ST  
Type: Contributor  
Year built: 1957  
Property type/sub type: Residential-Single Family; House  
Architectural style: Ranch, Traditional



Address: 726 W 172ND ST  
Type: Contributor  
Year built: 1957  
Property type/sub type: Residential-Single Family; House  
Architectural style: Ranch, Traditional



Address: 732 W 172ND ST  
 Type: Contributor  
 Year built: 1957  
 Property type/sub type: Residential-Single Family; House  
 Architectural style: Ranch, Traditional



Address: 738 W 172ND ST  
 Type: Contributor  
 Year built: 1957  
 Property type/sub type: Residential-Single Family; House  
 Architectural style: Ranch, Traditional



Address: 711 W 173RD PL  
 Type: Non-Contributor  
 Year built: 1961  
 Property type/sub type: Residential-Single Family; House  
 Architectural style: Ranch, Traditional



Address: 717 W 173RD PL  
 Type: Contributor  
 Year built: 1961  
 Property type/sub type: Residential-Single Family; House  
 Architectural style: Ranch, Traditional



Address: 723 W 173RD PL  
 Type: Contributor  
 Year built: 1961  
 Property type/sub type: Residential-Single Family; House  
 Architectural style: Ranch, Traditional



Address: 729 W 173RD PL  
 Type: Contributor  
 Year built: 1961  
 Property type/sub type: Residential-Single Family; House  
 Architectural style: Ranch, Traditional



Address: 735 W 173RD PL  
 Type: Non-Contributor  
 Year built: 1961  
 Property type/sub type: Residential-Single Family; House  
 Architectural style: Ranch, Traditional



Address: 750 W 173RD PL  
Type: Contributor  
Year built: 1961  
Property type/sub type: Residential-Single Family; House  
Architectural style: Ranch, Traditional



Address: 755 W 173RD PL  
Type: Contributor  
Year built: 1961  
Property type/sub type: Residential-Single Family; House  
Architectural style: Ranch, Cinderella



Address: 756 W 173RD PL  
Type: Non-Contributor  
Year built: 1961  
Property type/sub type: Residential-Single Family; House  
Architectural style: Ranch, Traditional



Address: 760 W 173RD PL  
Type: Contributor  
Year built: 1961  
Property type/sub type: Residential-Single Family; House  
Architectural style: Ranch, Traditional



Address: 764 W 173RD PL  
Type: Contributor  
Year built: 1961  
Property type/sub type: Residential-Single Family; House  
Architectural style: Ranch, Traditional



Address: 710 W 173RD ST  
Type: Contributor  
Year built: 1961  
Property type/sub type: Residential-Single Family; House  
Architectural style: Ranch, Traditional



Address: 711 W 173RD ST  
Type: Contributor  
Year built: 1961  
Property type/sub type: Residential-Single Family; House  
Architectural style: Ranch, Traditional



Address: 717 W 173RD ST  
 Type: Non-Contributor  
 Year built: 1961  
 Property type/sub type: Residential-Single Family; House  
 Architectural style: Ranch, Traditional



Address: 718 W 173RD ST  
 Type: Contributor  
 Year built: 1961  
 Property type/sub type: Residential-Single Family; House  
 Architectural style: Ranch, Traditional



Address: 721 W 173RD ST  
 Type: Contributor  
 Year built: 1961  
 Property type/sub type: Residential-Single Family; House  
 Architectural style: Ranch, Traditional



Address: 724 W 173RD ST  
 Type: Contributor  
 Year built: 1961  
 Property type/sub type: Residential-Single Family; House  
 Architectural style: Ranch, Traditional



Address: 727 W 173RD ST  
 Type: Non-Contributor  
 Year built: 1961  
 Property type/sub type: Residential-Single Family; House  
 Architectural style: Ranch, Traditional



Address: 732 W 173RD ST  
 Type: Contributor  
 Year built: 1961  
 Property type/sub type: Residential-Single Family; House  
 Architectural style: Ranch, Traditional



Address: 733 W 173RD ST  
 Type: Contributor  
 Year built: 1961  
 Property type/sub type: Residential-Single Family; House  
 Architectural style: Ranch, Traditional



Address: 736 W 173RD ST  
Type: Contributor  
Year built: 1961  
Property type/sub type: Residential-Single Family; House  
Architectural style: Ranch, Traditional



Address: 737 W 173RD ST  
Type: Non-Contributor  
Year built: 1961  
Property type/sub type: Residential-Single Family; House  
Architectural style: Ranch, Traditional



Address: 740 W 173RD ST  
Type: Contributor  
Year built: 1961  
Property type/sub type: Residential-Single Family; House  
Architectural style: Ranch, Traditional



Address: 800 W 173RD ST  
Type: Contributor  
Year built: 1961  
Property type/sub type: Residential-Single Family; House  
Architectural style: Ranch, Traditional



Address: 805 W 173RD ST  
Type: Contributor  
Year built: 1961  
Property type/sub type: Residential-Single Family; House  
Architectural style: Ranch, Traditional



Address: 806 W 173RD ST  
Type: Contributor  
Year built: 1961  
Property type/sub type: Residential-Single Family; House  
Architectural style: Ranch, Traditional



Address: 811 W 173RD ST  
Type: Contributor  
Year built: 1961  
Property type/sub type: Residential-Single Family; House  
Architectural style: Ranch, Traditional



Address: 815 W 173RD ST  
 Type: Contributor  
 Year built: 1961  
 Property type/sub type: Residential-Single Family; House  
 Architectural style: Ranch, Traditional



Address: 818 W 173RD ST  
 Type: Contributor  
 Year built: 1961  
 Property type/sub type: Residential-Single Family; House  
 Architectural style: Ranch, Traditional; Ranch, Oriental



Address: 819 W 173RD ST  
 Type: Contributor  
 Year built: 1961  
 Property type/sub type: Residential-Single Family; House  
 Architectural style: Ranch, Traditional



Address: 822 W 173RD ST  
 Type: Contributor  
 Year built: 1961  
 Property type/sub type: Residential-Single Family; House  
 Architectural style: Ranch, Traditional



Address: 823 W 173RD ST  
 Type: Contributor  
 Year built: 1961  
 Property type/sub type: Residential-Single Family; House  
 Architectural style: Ranch, Traditional



Address: 827 W 173RD ST  
 Type: Non-Contributor  
 Year built: 1961  
 Property type/sub type: Residential-Single Family; House  
 Architectural style: Ranch, Traditional



Address: 828 W 173RD ST  
 Type: Contributor  
 Year built: 1961  
 Property type/sub type: Residential-Single Family; House  
 Architectural style: Ranch, Traditional



Address: 831 W 173RD ST  
 Type: Contributor  
 Year built: 1961  
 Property type/sub type: Residential-Single Family; House  
 Architectural style: Ranch, Traditional



Address: 832 W 173RD ST  
 Type: Contributor  
 Year built: 1961  
 Property type/sub type: Residential-Single Family; House  
 Architectural style: Ranch, Traditional



Address: 837 W 173RD ST  
 Type: Contributor  
 Year built: 1961  
 Property type/sub type: Residential-Single Family; House  
 Architectural style: Ranch, Traditional



Address: 838 W 173RD ST  
 Type: Contributor  
 Year built: 1961  
 Property type/sub type: Residential-Single Family; House  
 Architectural style: Ranch, Oriental



Address: 841 W 173RD ST  
 Type: Not sure  
 Year built: 1961  
 Property type/sub type: Residential-Single Family; House  
 Architectural style: Ranch, Traditional



Address: 846 W 173RD ST  
 Type: Contributor  
 Year built: 1961  
 Property type/sub type: Residential-Single Family; House  
 Architectural style: Ranch, Traditional



Address: 847 W 173RD ST  
 Type: Contributor  
 Year built: 1961  
 Property type/sub type: Residential-Single Family; House  
 Architectural style: Ranch, Traditional



Address: 853 W 173RD ST  
Type: Non-Contributor  
Year built: 1961  
Property type/sub type: Residential-Single Family; House  
Architectural style: Ranch, Traditional



Address: 857 W 173RD ST  
Type: Contributor  
Year built: 1961  
Property type/sub type: Residential-Single Family; House  
Architectural style: Ranch, Traditional



Address: 861 W 173RD ST  
Type: Non-Contributor  
Year built: 1961  
Property type/sub type: Residential-Single Family; House  
Architectural style: Ranch, Traditional

#### Name: Roosevelt Memorial Park



#### Description:

Roosevelt Memorial Park is a cemetery and mortuary located in the Harbor Gateway area north of the 405 Freeway. It is bounded by Electric Street to the north, West 184th Street to the south, South Vermont Avenue to the east, and South Normandie Avenue to the west. The topography is generally flat. The park has a long, narrow rectangular shape with an east-west orientation. It is comprised of lawn space that is landscaped with trees. Mature trees include Chinese Elms, California Peppers, Corals, Oaks, and Camphors. There are also large numbers of olive trees. The trees are not landscaped in any particular pattern or plan. Roadways are symmetrical in plan; running east-west and terminating into semi-circles at each end. Typical of most memorial parks, the plaques are flush to the ground. The district contains several buildings and structures associated with the cemetery. Original features include stylized cast concrete entrance gate posts on South Normandie Avenue, a building that contains a Wurlitzer pipe organ, and a mortuary building. These latter two features are located near the center of the park. Non-contributors include several chapels and mausoleums located in the eastern portion of the cemetery that were added later.

#### Significance:

Roosevelt Memorial Park is significant for being the first and oldest memorial park developed in the Harbor Gateway area. The memorial park had its conceptual roots in the lawn park movement of the 19th century, which emphasized the idea of the cemetery as a place of recreation as well as burial. The land was previously occupied by the McKinley Home for Boys. When the directors of the home decided to move to a new larger home in the San Fernando Valley, they sold the 40-acre tract of land to a syndicate that developed the memorial park. The increasing population of Los Angeles during the 1910s and 1920s brought about a need for additional cemeteries.

The period of significance for the resource is 1924, when the park was originally established to 1949, the end of the period of significance for memorial parks in the overall historic context statement. The park was established as a burial place in 1924 and developed during the 1920s. Contributing features of the park consist of expansive lawn space landscaped with trees, concrete entrance gate posts on South Normandie Avenue constructed in the 1920s, a 1924 building that houses a Wurlitzer pipe organ, and a 1930s mortuary building. Several chapels added in the 1950s and mausoleum buildings added in the 1980s are non-contributors.

The park's main feature is a Wurlitzer pipe organ built in 1925, which is housed in a marble and granite building designed by architect A.C. Zimmerman. The organ was designed to be heard in an outdoor setting, with the audience seated on the lawn. The organ was shipped by train from the East Coast and assembled on site. The Los Angeles Times reported shortly after it was installed that the organ could be heard for up to five miles away.

Other examples of outdoor pipe organs existed, but they do not appear to have been numerous during this period. Extant examples include the Spreckles Organ in Balboa Park, San Diego; the Massey Memorial Organ in Chataqua, New York; and the Grove Stage at Bohemian Grove, an exclusive retreat north of San Francisco.

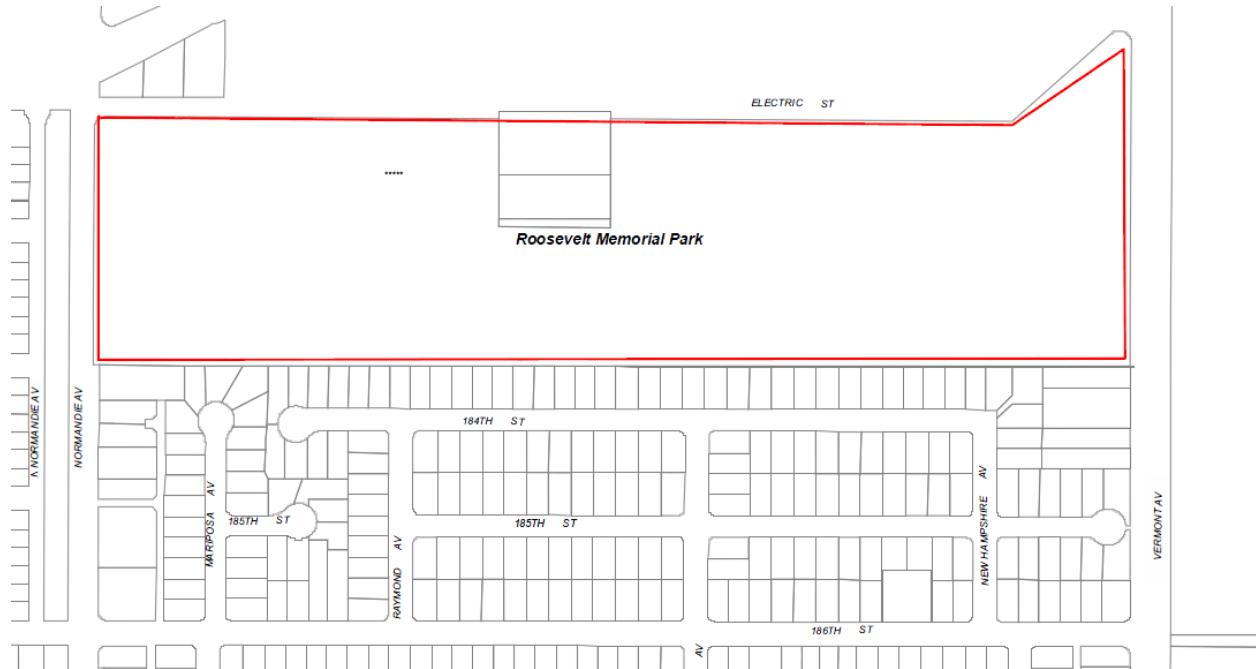

**Context 1:**

Context:	Cultural Landscapes, 1875-1980
Sub context:	Designed Landscapes, 1875-1980
Theme:	Burial and Memory, 1877-1980
Sub theme:	No SubTheme
Property type:	Landscape
Property sub type:	Cemetery
Criteria:	A/1/1 & C/3/3
Status code:	3S;3CS;5S3
Reason:	Roosevelt Memorial Park is the only memorial park in the Harbor Gateway area. It is relatively intact from its period of development during the 1920s. It also contains a building with a pipe organ that appears to be individually significant.