



FLOOR PLANS

Floor Plans submitted to the Los Angeles Department of City Planning shall comply with the following specifications. Additional materials or information may be required according to each type of application. For properties subject to Los Angeles Municipal Code (LAMC) [Sec. 11.5.7 \(Specific Plan Procedures\) of Chapter 1](#), [LAMC Article 3 \(Zoning Supplemental Use Districts\) of Chapter 1](#), or [LAMC Article 8 \(Supplemental & Special Zoning\) of Chapter 1A](#) check with the assigned planner **prior** to preparing these plans, as some have additional or different landscaping requirements. An [Assignment List](#) can be found on the City Planning website at <http://planning.lacity.org> under the “About” tab.

Floor Plans shall be of sufficient clarity to indicate the nature and extent of the proposed work and to demonstrate compliance with LAMC Chapter 1 or Chapter 1A, as applicable. Applications filed with Floor Plans that do not substantially conform with these instructions, or are unclear or illegible, will result in delays in application processing.

Technical Requirements

- Boundaries - Floor Plans shall include the entire building or premises subject to the approval.
- Walls - Shown as double lines. Walls that will be demolished to be shown as dashed or shadowed lines.
- Scale - No less than 1/16” to equal 1’.
- North Arrow.
- Street Address of project.
- All dimensions of the premises.
- Floor Area calculations in square feet for all notable areas per the definitions in [LAMC Section 12.03 \(Definitions\) of Chapter 1](#) or [LAMC Sec. 14.1.7.A. \(Floor Area\) of Chapter 1A](#).
- Amount of Patron Seating, Booth/Group Seating, and/or Private Dining/Banquet Room Seating for restaurants. Seats to be individually numbered.
 - For projects utilizing the Alcohol Sales Program, include the location of all alcohol storage and display areas.
- Include any outdoor areas that are a part of the project, including Open Space per [LAMC Section 12.21 \(General Provisions\) of Chapter 1](#), [Lot Amenity Spaces per LAMC Sec. 2C.3.1. of Chapter 1A](#), or [Residential Amenity Spaces per LAMC Sec. 2C.3.2. of Chapter 1A](#)

- Label individual areas, features, rooms, uses and major items of equipment (e.g. living room, auditorium, entry, freezers, stoves, etc...)

Interior Floor Plan

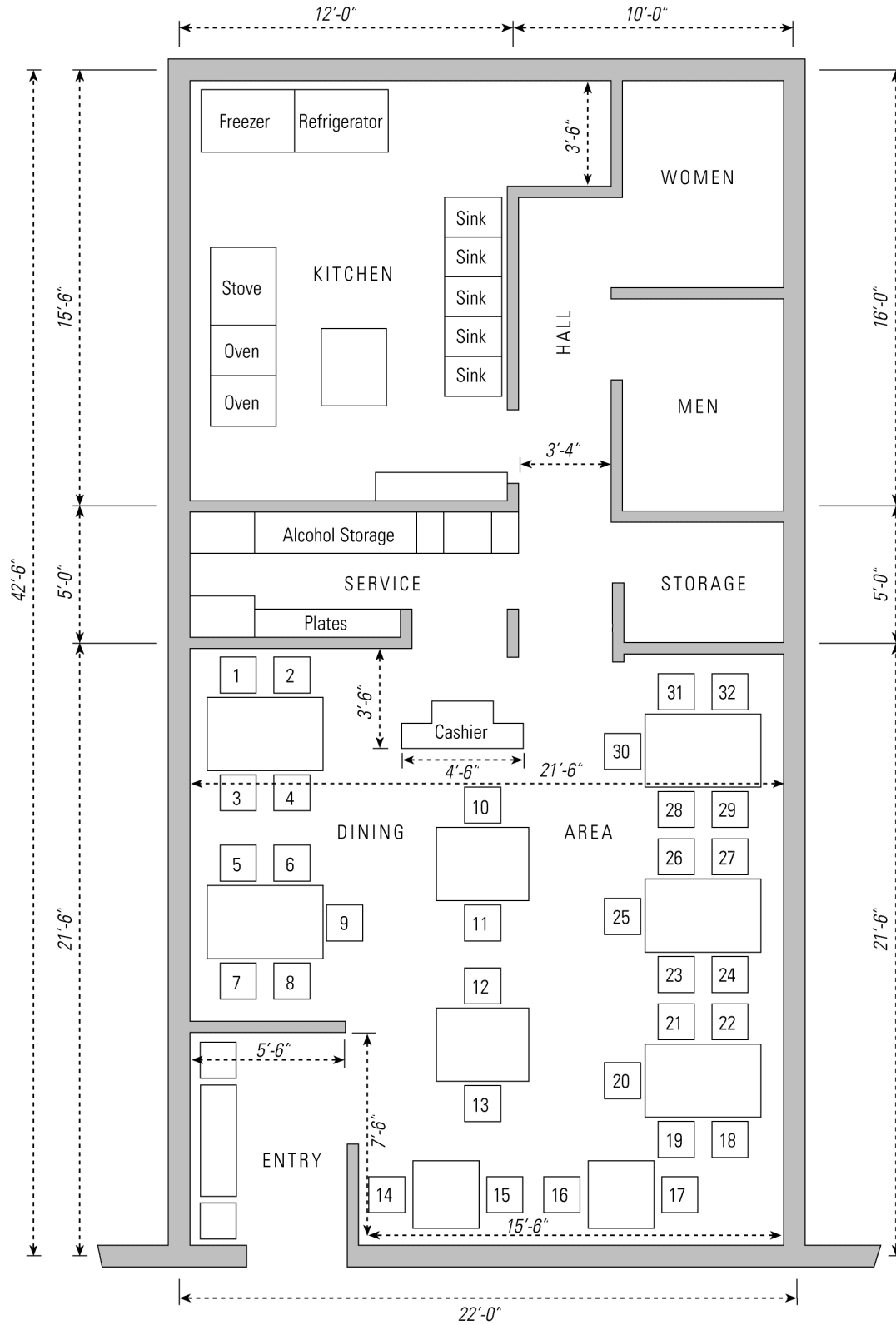

Scale: 3/16" = 1'0"