

ORDINANCE NO. 182764

An ordinance amending Section 12.04 of the Los Angeles Municipal Code by amending the zoning map.

THE PEOPLE OF THE CITY OF LOS ANGELES  
DO ORDAIN AS FOLLOWS:

Section 1. Section 12.04 of the Los Angeles Municipal Code is hereby amended by changing the zone and height district classifications of property shown upon a portion of the Zoning Maps incorporated therein and made a part of Article 2, Chapter 1 of the Los Angeles Municipal Code, so that such portion of the Zoning Maps shall conform to the zoning and height district classifications on those Maps attached hereto and incorporated herein by this reference:

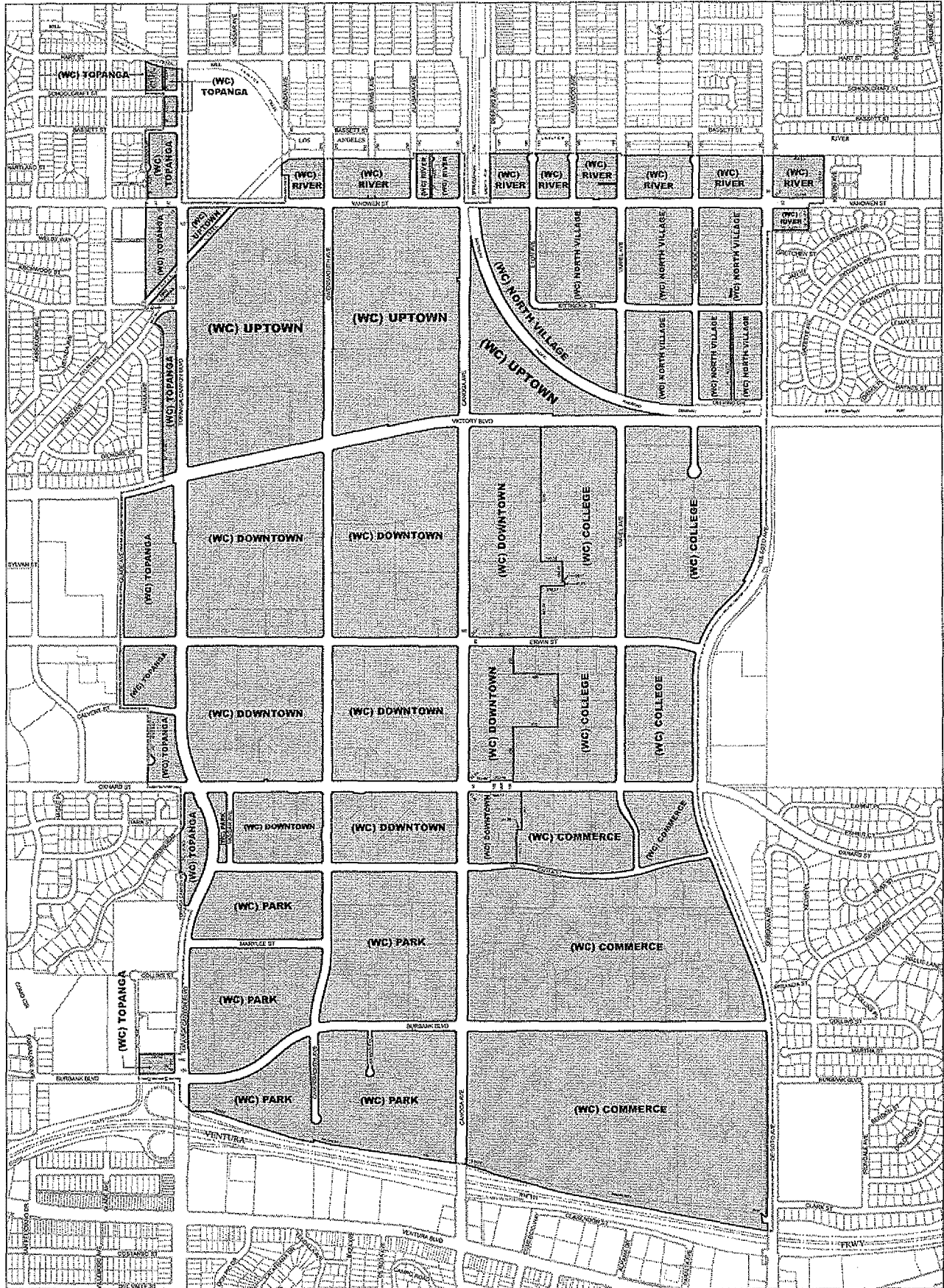

**Legend**

WARNER CENTER 2035 PLAN BOUNDARY

*Diagonal lines indicate the location of the boundary to be adopted with the zone boundaries.*

**ZONE CHANGE**  
**WARNER CENTER 2035 PLAN**  
 Canoga Park - Winnetka - Woodland Hills - West Hills

C.M. 183 B 101, 183 B 105, 183 B 109, 183 B 101, 180 B 105  
 182 B 108, 177 B 101, 177 B 105, 177 B 109, 174 B 101  
 174 B 105, 174 B 109, 171 B 105, 171 B 109

CPC 2008-3470-SP-GPA-SUD  
 669212

ALL BOUNDARIES FOLLOW EXISTING ZONE BOUNDARY LINES, EXCEPT WHERE NOTED.



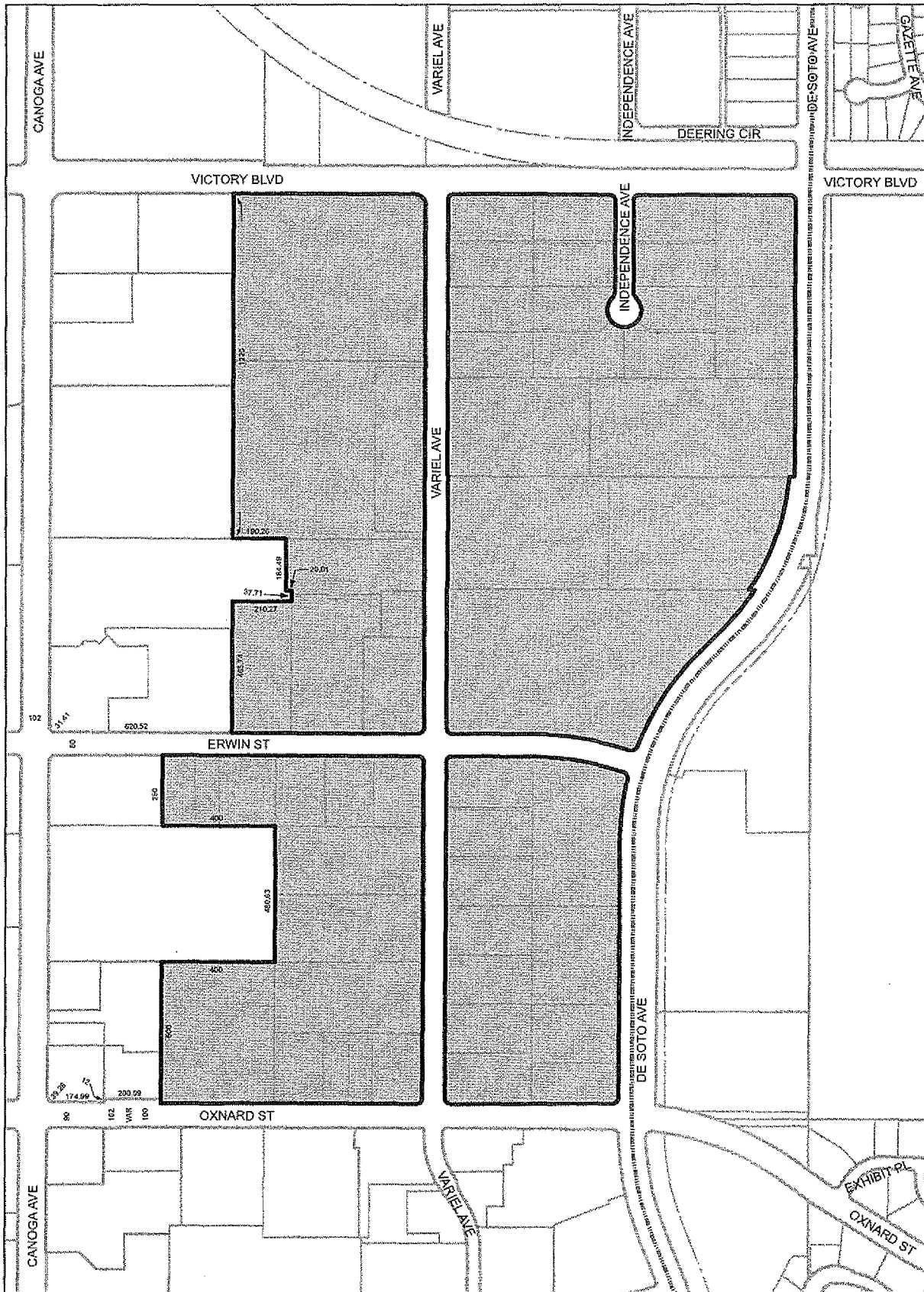

**CL (WC) COLLEGE**

10/11/11 11:12:11

**WARNER CENTER 2035 PLAN  
BOUNDARY**

(In some areas the Specific Plan  
Boundary is coincident with the  
zone boundaries.)



Data Source: Department of City Planning, Bureau of Engineering

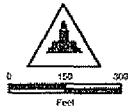

**ZONE CHANGE  
WARNER CENTER 2035 PLAN**

C.M. 180 B 105, 180 B 109  
177 B 105, 177 B 109

CPC-2008-3470-SP-GFA-SUD

012213



Area  
Mapped

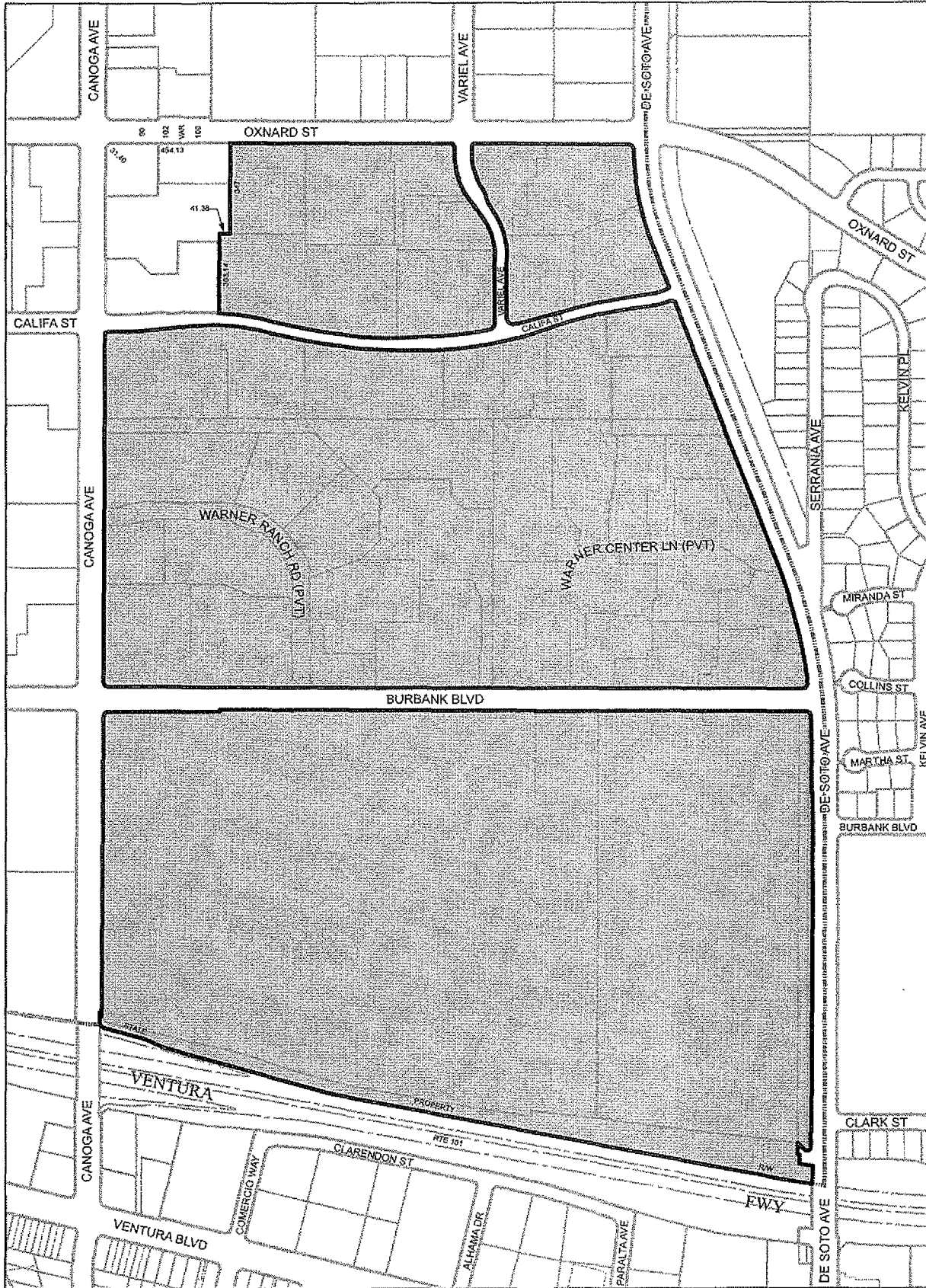

 **CO (WC) COMMERCE**

**WARNER CENTER 2035 PLAN BOUNDARY** (In some areas the Specific Plan Boundary is coincident with the zone boundaries.)



Data Sources: Department of City Planning, Bureau of Engineering



**ZONE CHANGE  
WARNER CENTER 2035 PLAN**

C.M. 177 B 105, 177 B 109, 174 B 105  
174 B 109, 171 B 105, 171 B 109

CPC-2008-3470-SP-GPA-SUD

012213



Area Mapped

AM

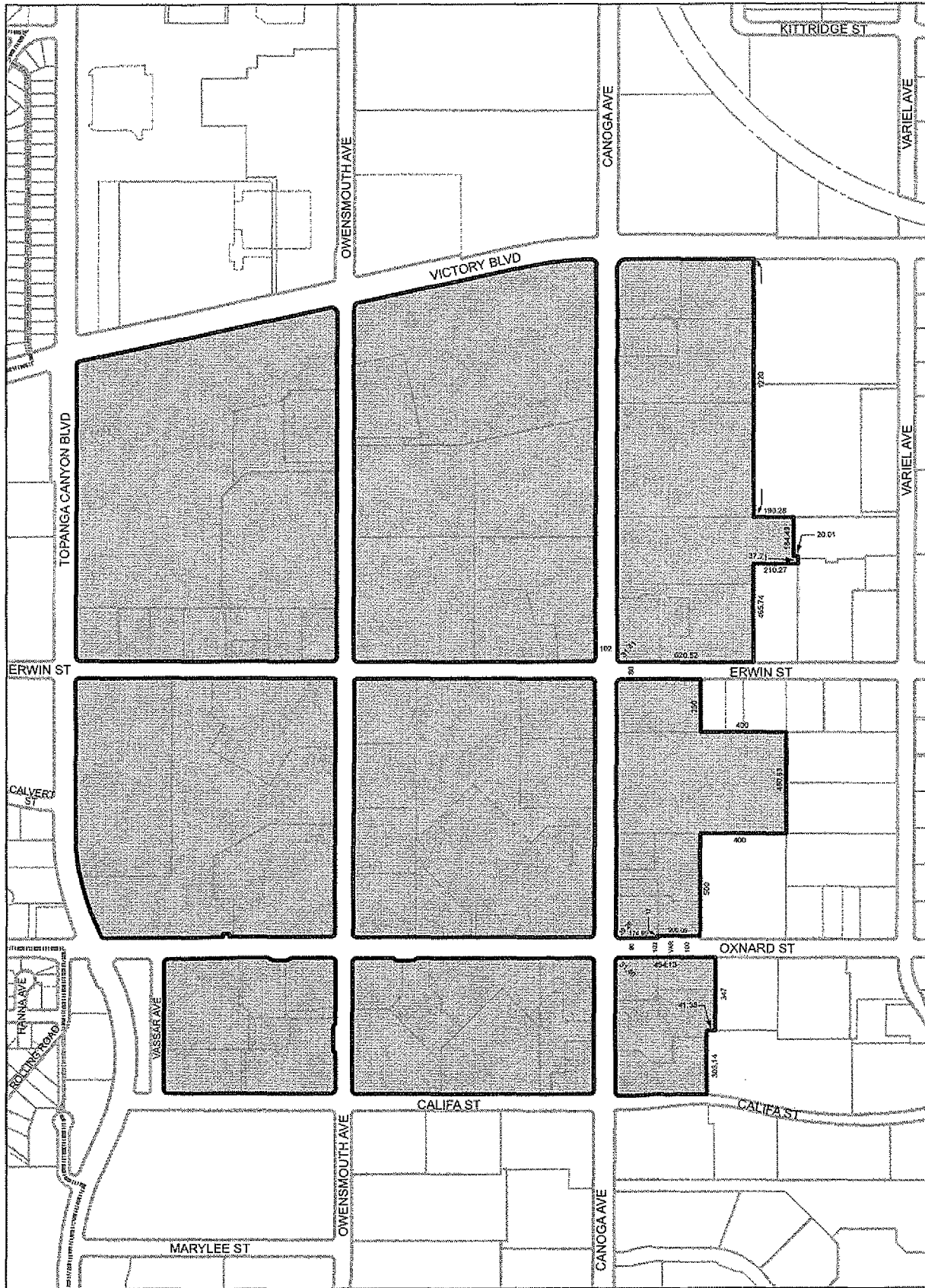

**DT (WC) DOWNTOWN**

WARNER CENTER 2035 PLAN

**BOUNDARY**

(In some areas the Specific Plan Boundary is coincident with the zone boundaries.)



Data Source: Department of City Planning, Berkeley of Engineering



**ZONE CHANGE**  
WARNER CENTER 2035 PLAN

C.M. 180 B 101, 180 B 105  
177 B 101, 177 B 105

CPC-2008-3470-SP-GPA-SUD

012213



Area Mapped

AV

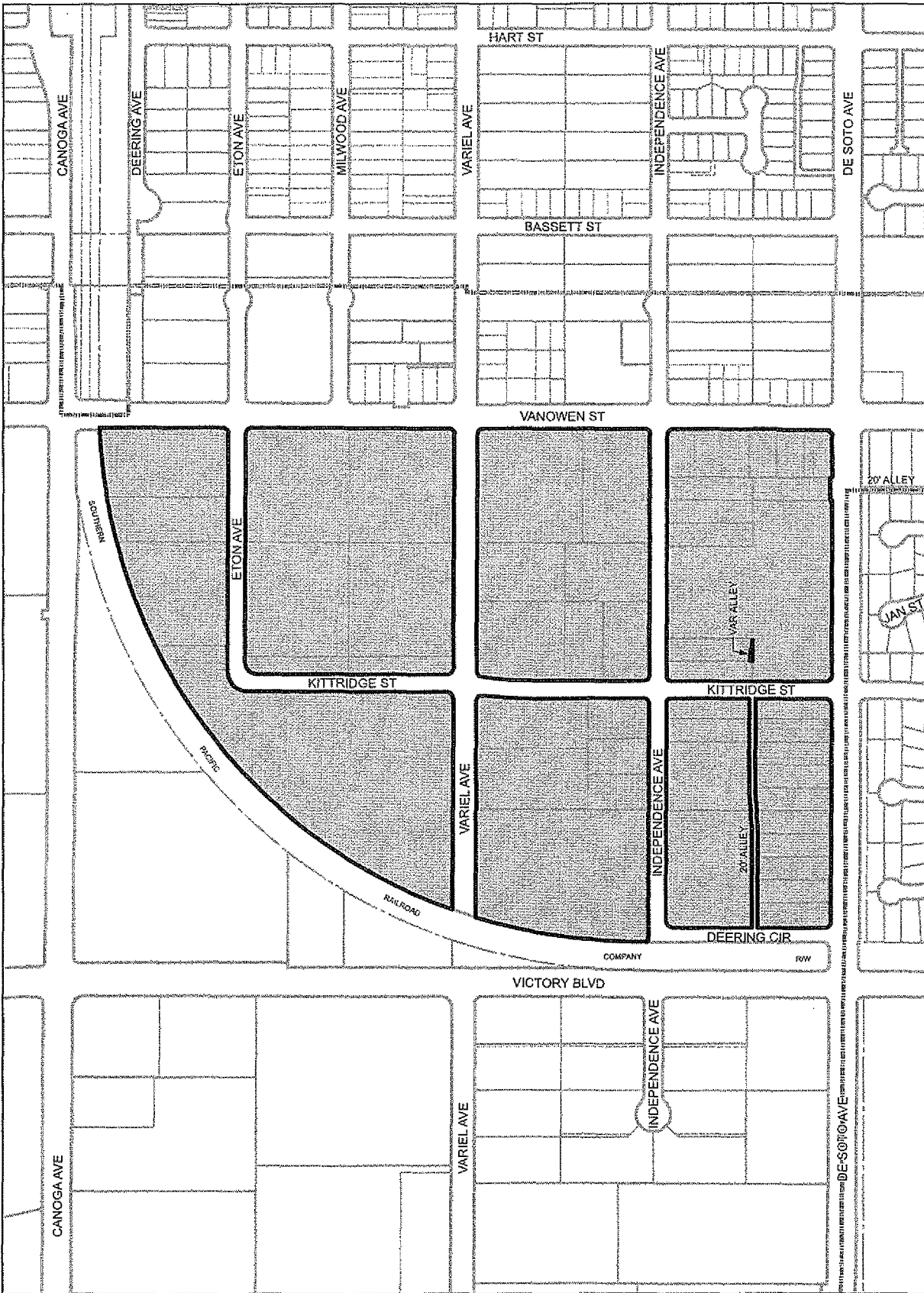

**NV (WC) NORTH VILLAGE**

WARCEN2035-11-05-0107

**WARNER CENTER 2035 PLAN BOUNDARY**

(In some areas the Specific Plan Boundary is coincident with the zone boundaries.)



**ZONE CHANGE**  
**WARNER CENTER 2035 PLAN**

C.M. 180 B 105, 180 B 109      CPC-2008-3470-SP-GPA-SUD

AA/

012313



Area Mapped

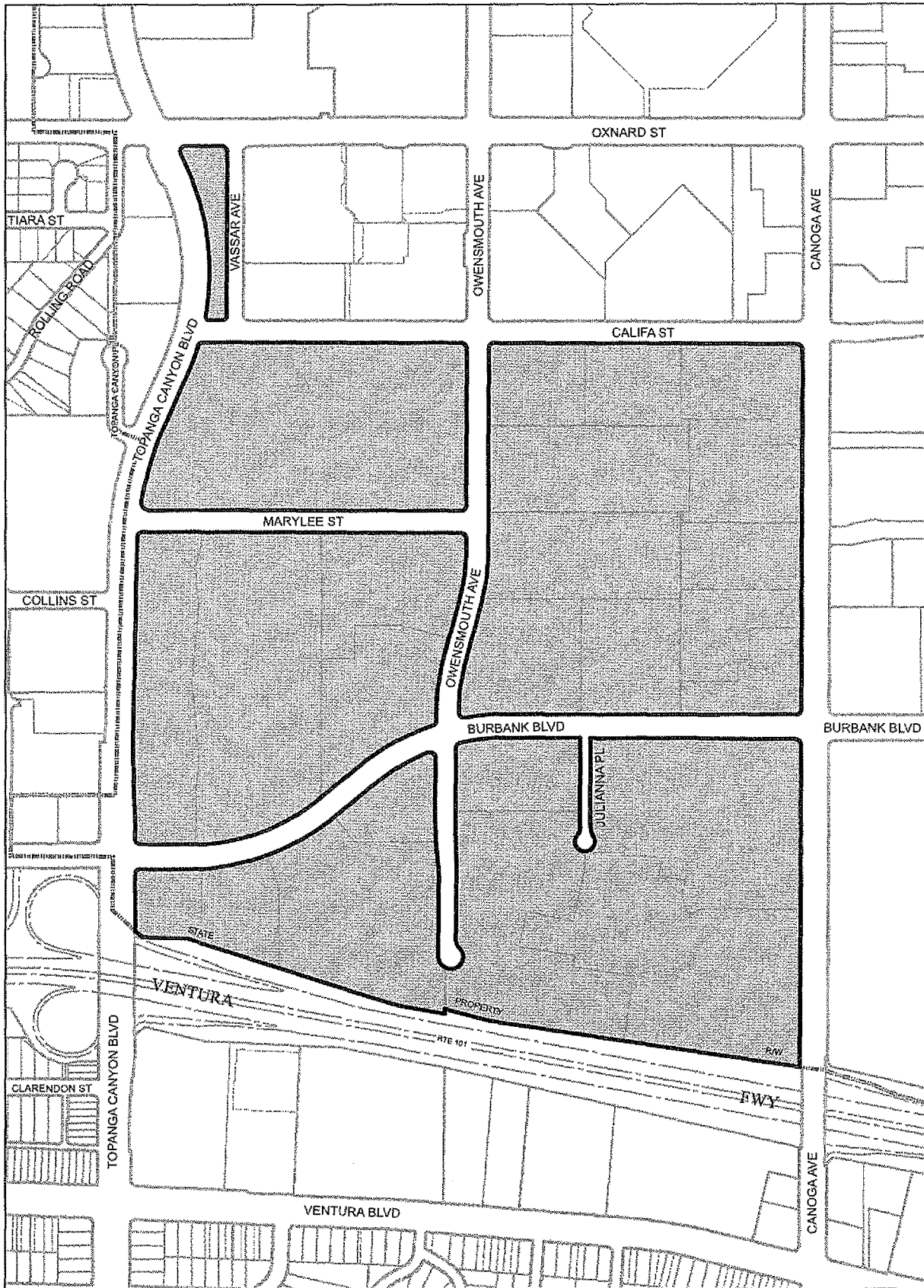

 **PK (WC) PARK**

WARNER CENTER 2035 PLAN  
**BOUNDARY** (In some areas the Specific Plan  
 Boundary is coincident with the  
 zone boundaries.)



Data Source: Department of City Planning, Bureau of Engineering



**ZONE CHANGE**  
 WARNER CENTER 2035 PLAN

C.M. 177 B 101, 174 B 101  
 174 B 105

CPC-2008-3470-SP-GPA-SUD

012313



Area  
 Mapped

AAV

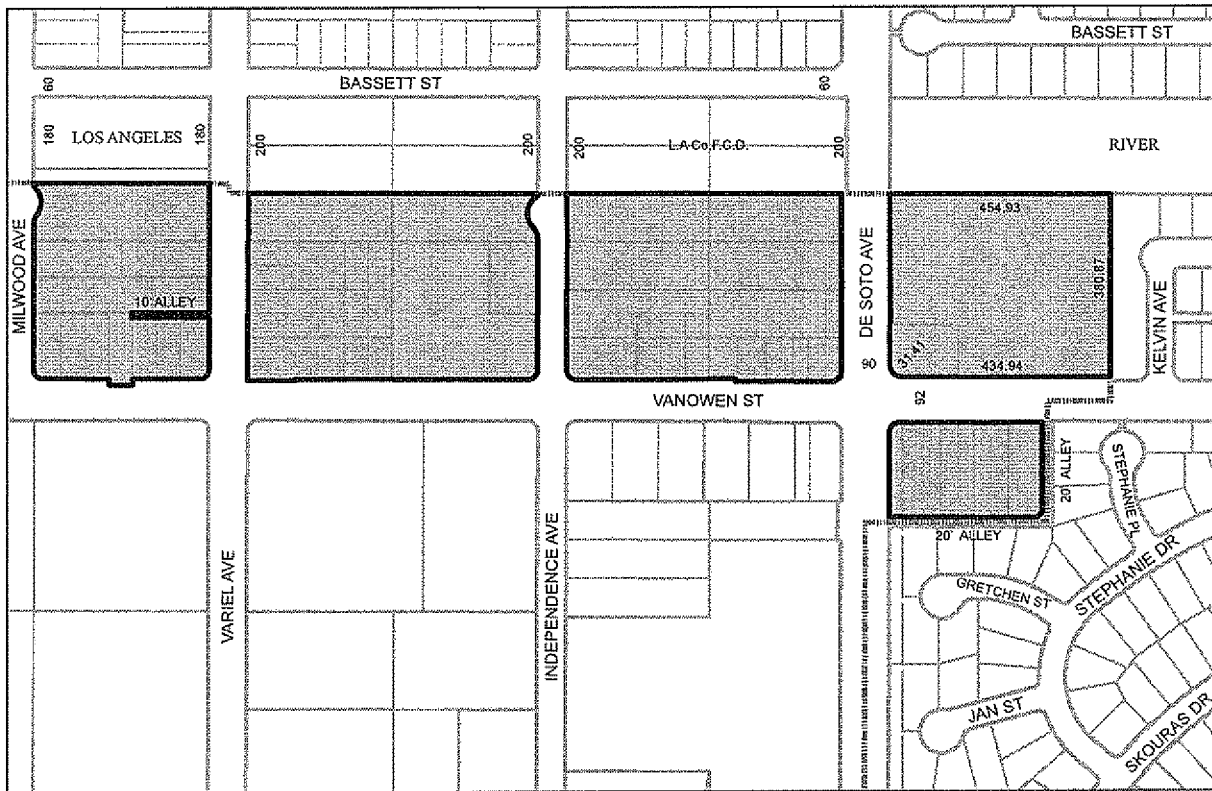
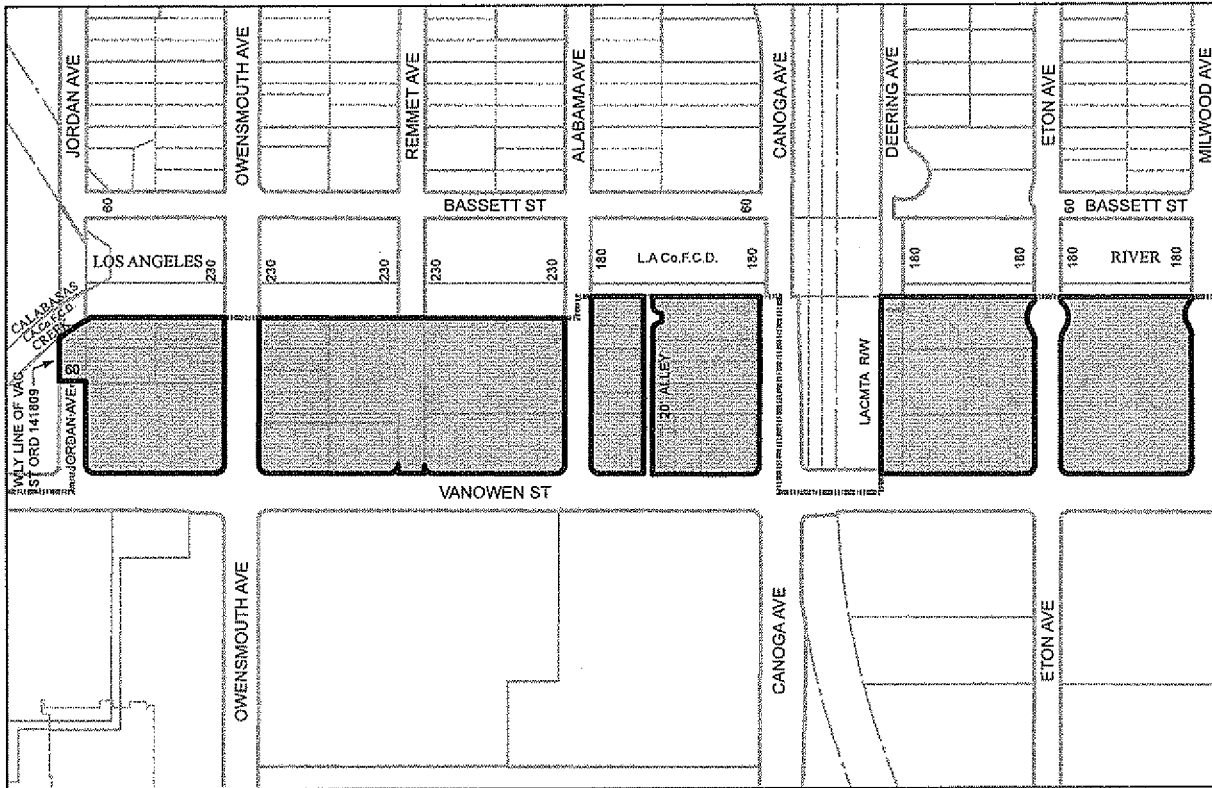

 **RV (WC) RIVER**

WARNER CENTER 2035 PLAN  
**BOUNDARY** (In some areas the Specific Plan Boundary is coincident with the zone boundaries.)



Data Source: Department of City Planning, Bureau of Engineering

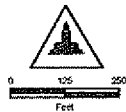

**ZONE CHANGE**  
 WARNER CENTER 2035 PLAN

C.M. 183 B 105, 183 B 109, 160 B 109      CPC-2008-3470-SP-GPA-SUD

AM

012415



Area Mapped



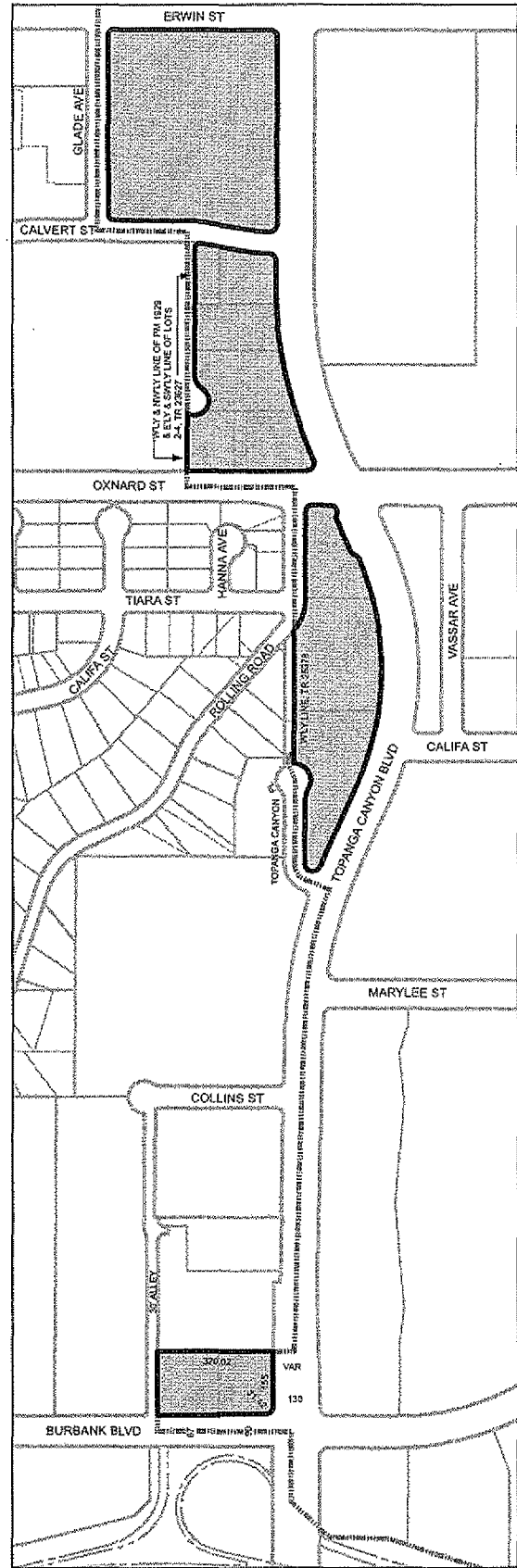
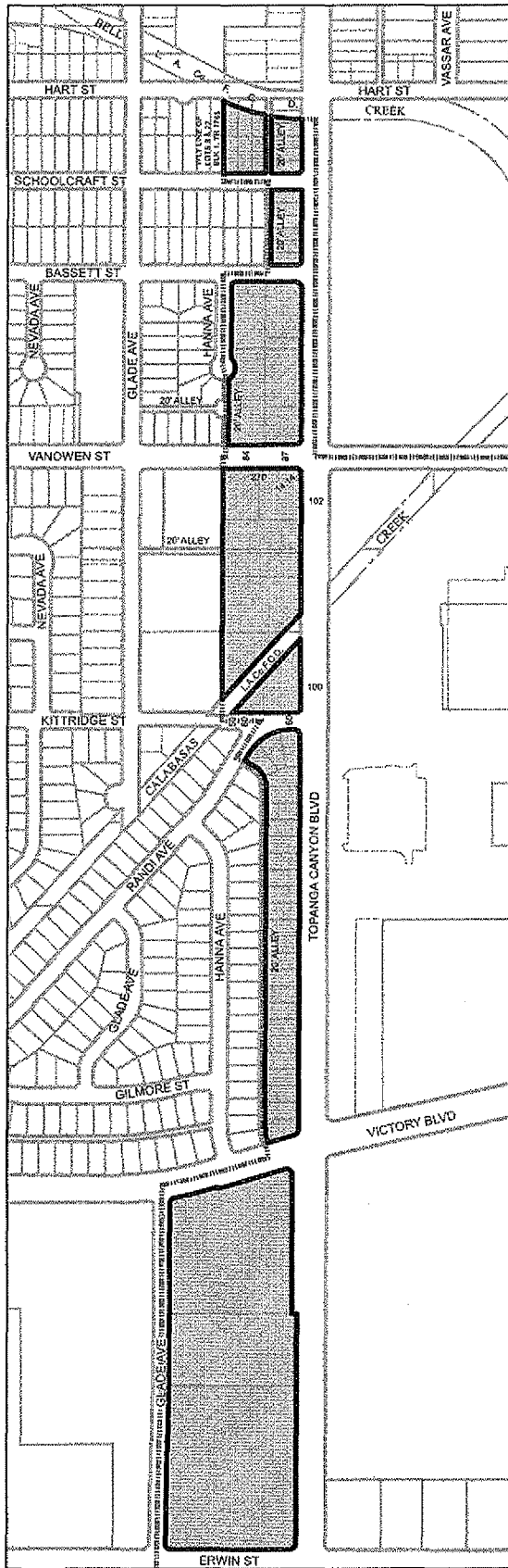

 **TP (WC) TOPANGA**

WARNER CENTER 2035 PLAN  
**BOUNDARY** (in some areas the Specific Plan Boundary is coincident with the zone boundaries.)



City Sources: Department of City Planning, Bureau of Engineering



**ZONE CHANGE**  
**WARNER CENTER 2035 PLAN**

C.M. 183 B 101, 180 B 101  
 177 B 101, 174 B 101

CPC-2008-3470-SP-GPA-SUD

013013



Area Mapped

AV

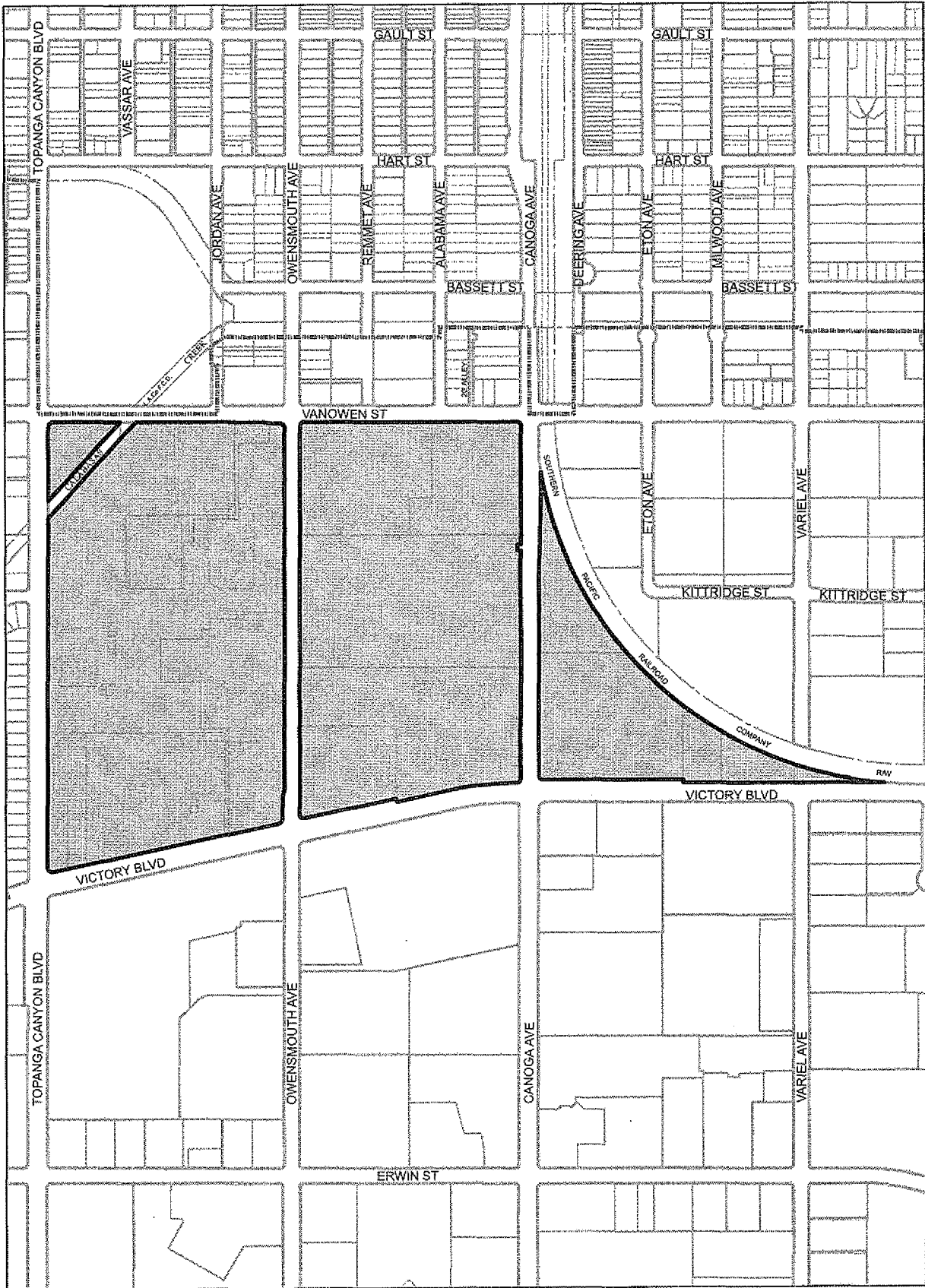

 **UT (WC) UPTOWN**

WARNER CENTER 2035 PLAN  
**BOUNDARY** (In some areas the Specific Plan Boundary is coincident with the zone boundaries.)



Data Sources: Department of City Planning, Bureau of Engineering

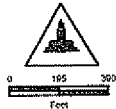

**ZONE CHANGE**  
**WARNER CENTER 2035 PLAN**

C.M. 180 B 101, 180 B 105      CPC-2008-3470-SP-GPA-SUD

AAV

012413



Area Mapped

Section \_\_. The City Clerk shall certify to the passage of this ordinance and have it published in accordance with Council policy, either in a daily newspaper circulated in the City of Los Angeles or by posting for ten days in three public places in the City of Los Angeles: one copy on the bulletin board located at the Main Street entrance to the Los Angeles City Hall; one copy on the bulletin board located at the Main Street entrance to the Los Angeles City Hall East; and one copy on the bulletin board located at the Temple Street entrance to the Los Angeles County Hall of Records.

I hereby certify that the foregoing ordinance was introduced at the Council of the City of Los Angeles, by a majority vote of all its members, at the meeting of OCT 23 2013.

\_\_\_\_\_  
Holly L. Wolcott, City Clerk

By \_\_\_\_\_

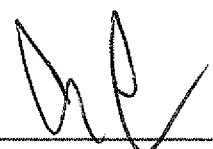

Deputy

Approved \_\_\_\_\_ ✓ (OCT 30 2013)



Mayor

Pursuant to Section 558 of the City Charter, the City Planning Commission on November 29, 2012, recommended this ordinance be adopted by the City Council.

\_\_\_\_\_  
James K. Williams, Commission Executive Assistant II  
City Planning Commission

File No. 13-0197

## DECLARATION OF POSTING ORDINANCE

I, MARIA VIZCARRA, state as follows: I am, and was at all times hereinafter mentioned, a resident of the State of California, over the age of eighteen years, and a Deputy City Clerk of the City of Los Angeles, California.

Ordinance No. 182764 – Zone Change for property at the Warner Center 2035 Plan for the Canoga Park – Winnetka – Woodland Hills – West Hills Community Plan area – CPC 2008-3470-SP-GPA-SUD - a copy of which is hereto attached, was finally adopted by the Los Angeles City Council on October 23, 2013, and under the direction of said City Council and the City Clerk, pursuant to Section 251 of the Charter of the City of Los Angeles and Ordinance No. 172959, on November 1, 2013 I posted a true copy of said ordinance at each of the three public places located in the City of Los Angeles, California, as follows: 1) one copy on the bulletin board located at the Main Street entrance to the Los Angeles City Hall; 2) one copy on the bulletin board located at the Main Street entrance to the Los Angeles City Hall East; 3) one copy on the bulletin board located at the Temple Street entrance to the Los Angeles County Hall of Records.

Copies of said ordinance were posted conspicuously beginning on November 1, 2013 and will be continuously posted for ten or more days.

I declare under penalty of perjury that the foregoing is true and correct.

Signed this 1st day of November, 2013 at Los Angeles, California.

  
\_\_\_\_\_  
Maria Vizcarra, Deputy City Clerk

Ordinance Effective Date: December 11, 2013  
Rev. (2/21/06)

Council File No. 13-0197