

PROJECT:
 13301 VENTURA BLVD.
 SHERMAN OAKS, CA 91423



Design Universal
 ARCHITECTURAL AND DESIGN
 ROBERT THRODEAU
 875 LINCOLN BLVD
 VENTURA, CA 93141
 PH: 310 452 8161
 FX: 310 452 8171

OWNER:
 Christy Vega
 13301 Ventura Blvd
 Sherman Oaks, CA 91423
 PH: 618,768,4868
 Email: christy.vega@gsa.com

STRUCTURAL ENGINEERING & SURVEYING
 PETER T. ERDELYI ASSOCIATES
 2989 Overland Ave. Suite 103
 Los Angeles, CA 90004
 PH: 310.553.0339
 Email: peter@erdeli.com

MEP ENGINEERS:
 GMEP ENGINEERS
 20435 Rancho Pkwy S, STE #120
 Lake Forest, CA 92540
 PH: 949.287.3000
 Email: kurtv@gmep.com

EXPECITER:
 FE Design & Consulting
 327 E. 2nd St. #222
 Los Angeles, CA 90012
 PH: 213.548.2620
 Email: wafie@fedesignandconsulting.com

INTERIOR DESIGNER:
 Farhaad Goodard Design Studio
 PH: 323.493.7848
 Email: fg@farhaadgoodard.com

REVISION #	DESCRIPTION	DATE
1	ISSUE FOR PERMITS	08.30.2024
2	NO. 100 CHECK	09.18.2024
3	NO. 100 CHECK REVISIONS	09.24.2024
4	NO. 100 CHECK COMMENTS	11.21.2024
5	NO. 100 CHECK RFS	12.23.2024

ROOF PLAN

DATE: 04.22.24 DRAWN: BK SCALE: 1/8" = 1'-0"

A2.02

EXHIBIT "A"
 Page No. 4 of 10
 Case No. ZA-2023-4240-CU-CUB-SPP

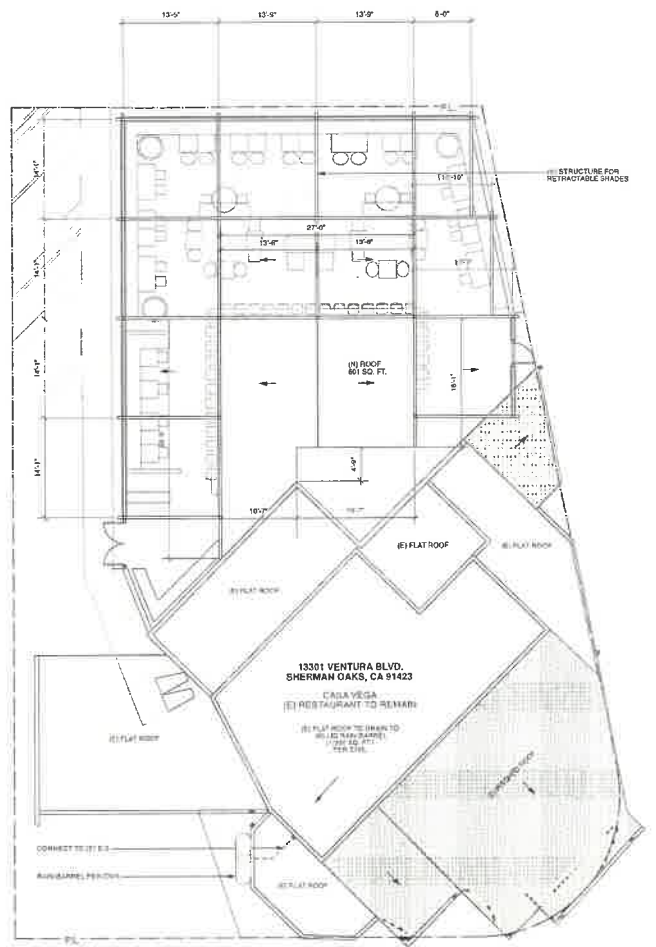

PROPOSED ROOF PLAN
 Scale: 1/8" = 1'-0" ①

SYMBOL	DESCRIPTION	NOTES
(A) ROOF	801 SQ. FT.	
(B) ROOF		
(C) ROOF		
(D) ROOF		
(E) ROOF		
(F) ROOF		
(G) ROOF		
(H) ROOF		
(I) ROOF		
DOOR NUMBER		(E) FOOTING 12" WIDE MIN. (ASSUMED) CONTRACTOR TO VERIFY
WINDOW NUMBER	B	4X POSTS WITH HUB TYP. I.I.N.O. (B) FRAMING CONTRACTOR TO VERIFY