

ADDRESS	806 E. 3RD ST. #140 LOS ANGELES, CA 90013
LANDLORD INFO	ROCK-HILL HOLDINGS, LLC
AFN NUMBER	5163015028 / 5163015016
LEGAL DESCRIPTION	THOMAS TRACT, BLOCK H, FR 15-17, ARB 2
LOT SIZE	0.344 AC
ZONING	M3-1-R10
FIN NUMBER	129A215 316 / 129A215 311
BUSINESS NAME	TABERU
BUSINESS OWNER	AD EMOTION USA LLC
TOTAL SQ. FT.	2,100 SQ.FT.
BUILDING HEIGHT	16'-11"
LANDSCAPE	N/A
OPEN SPACE	643 SQ.FT.
PLAN CHECK NUMBER	NA
SCOPE OF WORK	T.I. WORK FOR NEW JAPANESE RESTAURANT
TOTAL # OF SEAT	61 INDOOR / 34 OUTDOOR
AREA CALCULATION	KITCHEN : 375 SQ.FT. WASH AREA : 115 SQ.FT. WALK INS : 90 SQ.FT. DINING AREA : 1097 SQ.FT. STORAGE : 57 SQ.FT. RESTROOM : 153 SQ.FT. HALLWAY : 156 SQ.FT. RECEPTION : 57 SQ.FT. TOTAL : 2,100 SQ.FT. OUTDOOR PATIO : 643 SQ.FT.
PARKING REQUIRED	PARKING WILL BE PROVIDED PER ZA-2016-4497-MCUP-ZV. NO CHANGE IN PARKING

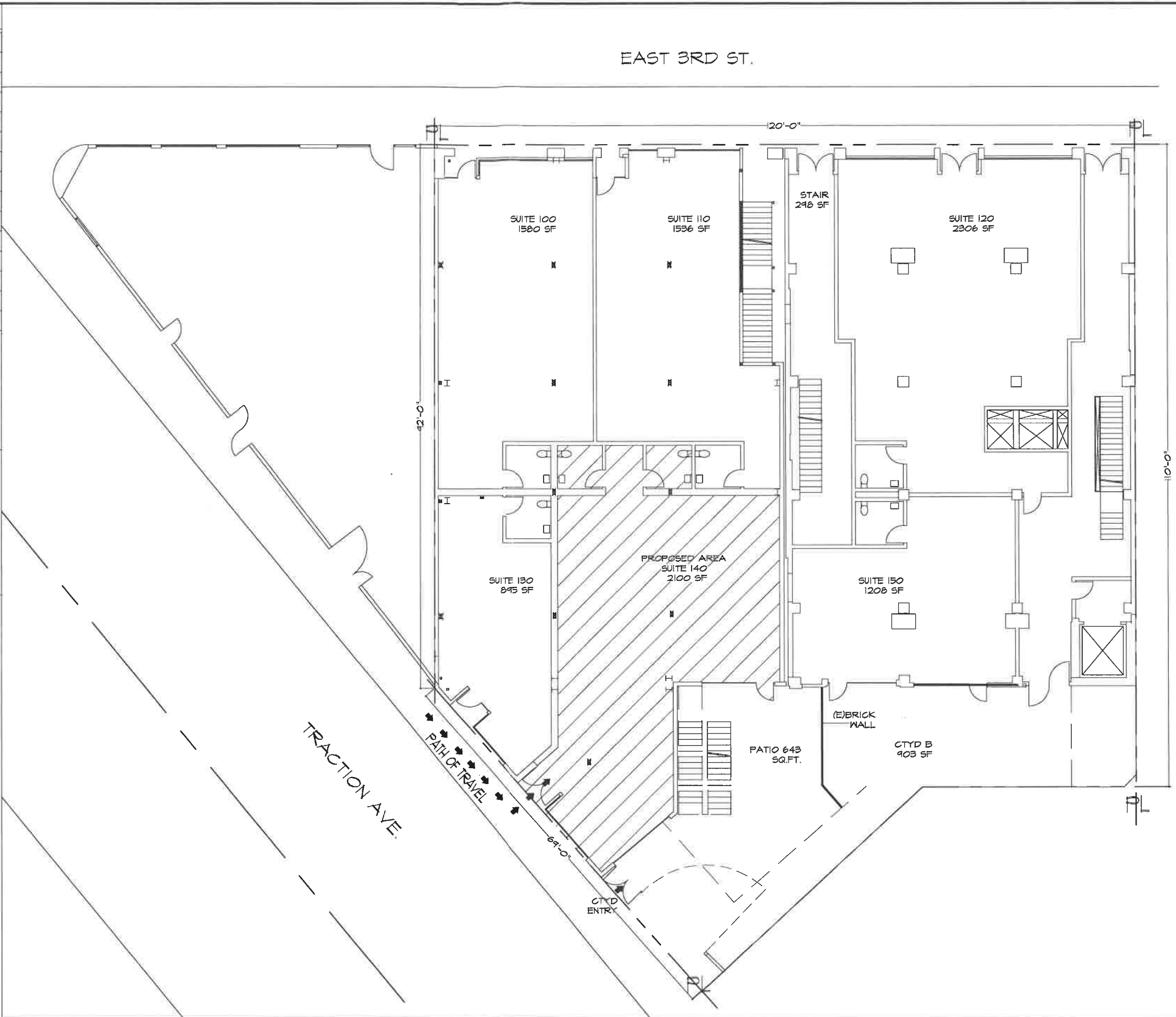

PLOT PLAN

EAST 3RD ST.

120'-0"

110'-0"

42'-0"

69'-0"

STAIR  
246 SF

SUITE 100  
1580 SF

SUITE 110  
1536 SF

SUITE 120  
2306 SF

SUITE 130  
895 SF

PROPOSED AREA  
SUITE 140  
2100 SF

SUITE 150  
1208 SF

SUITE 155  
903 SF

PATIO 643  
SQ.FT.

(E) BRICK WALL

CTYD B  
903 SF

CTYD  
ENTRY

TRACTION AVE.

PATH OF TRAVEL

NORTH

SCALE : 1/8" = 1'-0"

PRESCA LEE IS NOT RESPONSIBLE FOR ANY TYPE OF LIABILITY TOWARD THIS CONSTRUCTION DOCUMENT. THE ONLY PRESCA LEE WILL BE RESPONSIBLE FOR THE LIABILITY OF THIS CONSTRUCTION DOCUMENT IS WHEN PRESCA LEE IS HIRED AS THE CONTRACTOR FOR THE PROJECT. THIS DOCUMENT IS ONLY FOR THE INFORMATION.

THE ABOVE DRAWING, SPECIFICATION, IDEAS, DESIGNS, AND ARRANGEMENTS ARE AND WILL REMAIN THE PROPERTY OF THE ARCHITECT. NO PART THERE OF SHALL BE REPRODUCED, COPIED, ADAPTED, DISCLOSED, DISTRIBUTED, SOLD, PUBLISHED, TRANSFERRED TO ANOTHER ARCHITECT, USED OR BUILT IN ANY MANNER, WITHOUT THE PRIOR WRITTEN CONSENT OF AND WITHOUT APPROPRIATE COMPENSATION TO THE ARCHITECT. VISUAL CONTACT WITH THE ABOVE DRAWING OR SPECIFICATION SHALL CONSTITUTE EVIDENCE OF ACCEPTANCE OF THESE RESTRICTIONS.

**iNarc INC.**  
Interior Design, Planning and  
Constructions  
Tel: 213-402-1115 Fax: 323-781-4007  
22028 15th ave. Los Angeles, CA

PROJECT PROJECT  
**TABERU**  
806 E. 3RD ST. #140  
LOS ANGELES, CA 900013

SHEET NO.:  
**A-1**

DATE: 03/11/2022  
DRAWN BY: PRESCA S. LEE  
CHECKED BY:

EXHIBIT "A"  
Page No. 2  
Case No. ZA-2022-3614-MPA

COPYRIGHT NOTICE: USE OF THESE DRAWINGS AND SPECIFICATIONS IS RESTRICTED TO THE ORIGINAL PROJECT SITE FOR WHICH THEY WERE INTENDED. REUSE OR REPRODUCTION IN WHOLE OR IN PART IS PROHIBITED. TITLE TO DRAWINGS AND SPECIFICATIONS INCLUDING ALL DESIGN IDEAS AND INFORMATION REMAINS WITH THE DESIGNER. VISUAL CONTACT WITH THESE DRAWINGS AND SPECIFICATIONS CONSTITUTE EVIDENCE OF THE ACCEPTANCE OF THESE RESTRICTIONS.